

# **Atlantic County Fire Academy/Fire Training Center**

## **TRAINING COURSE ANNOUNCEMENT**



**Spring 2026**

**“PRESIDENT”**

**Charles Mackintosh**

**1st VICE PRESIDENT**

**Dennis Sharpe**

**2nd VICE PRESIDENT**

**William Merola, Jr.**

**SECRETARY**

**Robert A. Mellon**

**TREASURER**

**Jaime C. Mellon**

**ASSISTANT SECRETARY/TREASURER**

**Clayton E Tucker**

**“EXECUTIVE COMMITTEE”**

**CHAIRMAN**

**Howard Berchtold, Jr.**

**Levon “Lefty” Clayton, Vice Chairman**

**Marc J. Corsiglia**

**Kimball Feinstein**

**Joseph Hartman**

**Walter "Butch" Kienzle, III**

**Christopher Kislow**

**Eugene M. Sharpe**

**Charles “Rob” Winkler III**

**“ATLANTIC COUNTY DIRECTOR OF FIRE TRAINING”**

**Brian Middleton**

**“FIRE TRAINING CENTER INSTRUCTORS”**

**Dan Adams**

**Jamison Allen**

**David Buzby**

**Daune Brock**

**Michael Cahill**

**Perry Coker**

**Michael Corbo**

**Thomas J. Culleney**

**Patrick Flynn**

**Eric Grace**

**Marylynn Graham**

**William Hancock**

**Sherman Hartman**

**William Higbee**

**Casey Hunt**

**Chris Kislow**

**Peter Libretti**

**Sean Macri**

**William Merola**

**Eric Moran**

**Louis Raciti**

**Joseph Rush**

**Louis Raciti**

**Joseph Rush**

**Kolby Rundio**

**Dennis Sharpe**

**Joseph Ward**

**Timothy Welsh**

**William Wilkinson**

**Charles “Rob” Winkler III**

**Brandon Zonge**

Atlantic County Fire Academy  
Spring 2026 Class Schedule  
Table of Contents

	<b>Page #</b>
ACFFA Officers & Executive Board	i
ACFA Instructors	i
Calendar	iv
Purpose	1
Prerequisites	1
Application Procedures	1
Confirmation	2
Cancellation Policy	2
Refund Policy	2
Substitutions	2
Walk-in Registration	2
Physical Conditions of Students	3
First Session Registration and Attendance	3
Make-up Policy	3
Dress Codes	
Beards & Self-contained Breathing Apparatus	4
Personal Protective Equipment	4
SCBA Use	4
Certificate of Insurance	5
Financial Responsibility for Medical Treatment	5
Use of Atlantic County Fire Academy for Live Burns	5
Other Seminar Offerings	6
Firefighter I: Rules & Regulations	7-8
Firefighter I Agility Test	9-10
Firefighter I: Present Semester Schedule	11-12
Firefighter II: Present Semester Schedule	13

Course Offerings:

**Atlantic County Fire Academy Programs:**

Firefighter I	14
Firefighter II	14
Basic Pump Operations	15
Advance Pump Operations	15
Sizing up Incident	16
Wednesday Night Live Burn	17
Flashover Awareness	18
Rope Rescue I	19
Rope Rescue II	19
ICS-200	20
First Due	20
Thermal Imaging	21
NEW COURSE Rapid Intervention Crew	22

Atlantic County Fire Academy  
Spring 2026 Class Schedule  
Table of Contents

Firefighter I Registration Form	23
Firefighter I Medical Form	24 – 25
SCBA Fit Test Certification	26
How to Access NJDFS Registration Portal	27
Registration Forms	28-32

# January 26

SUNDAY	MONDAY	TUESDAY	WEDNESDAY	THURSDAY	FRIDAY	SATURDAY
				1 New Years Day	2	3
4	5	6 <i>Fire Officer II</i>	7	8 <i>Fire Officer II</i>	9	10 <i>Fire Officer II</i>
11	12	13 <i>Fire Officer II</i>	14	15 <i>Fire Officer II</i>	16	17 <i>Fire Officer II</i>
18	19 Martin Luther King Day	20 <i>Fire Officer II</i>	21	22 <i>Fire Officer II</i>	23	24 <i>Fire Officer II</i>
25	26	27	28	29	30	31

# February 26

SUNDAY	MONDAY	TUESDAY	WEDNESDAY	THURSDAY	FRIDAY	SATURDAY
1	2	3	4	5	6	7
8	9	10	11	12	13	14
15	16	17	18	19 FFI REGISTRATION	20	21
22 FFI AGILITY TEST/FIT TEST	23	24 FFI ORIENTATION	25	26 FFI SAFETY	27	28

# March 25

SUNDAY	MONDAY	TUESDAY	WEDNESDAY	THURSDAY	FRIDAY	SATURDAY
<b>1</b>  TIMS	<b>2</b>	<b>3</b> FFI FIRE BEHAVIOR	<b>4</b>  OPEN FLASH	<b>5</b> FFI HNA LECT	<b>6</b>	<b>7</b>
<b>8</b> FFI HNA DRILL 1	<b>9</b>  FFII REG/REPORT WRITING	<b>10</b>  FFI SCBA LECT	<b>11</b>  FFII BLDG CONST.	<b>12</b> FFI SCBA DRILL 1	<b>13</b>	<b>14</b>  <i>SCENE SIZE-UP</i>
			<i>OPEN LIVE BURN</i>			
<b>15</b>  HMA	<b>16</b> FFII ADVANCE VENT	<b>17</b>  FFI LADDER LECT	<b>18</b>  FFII FOAM OPS	<b>19</b>  FFI LADDER DRILL 1	<b>20</b>	<b>21</b>  FFII FOAM/HOSE TESTING
<b>22</b>  HMO	<b>23</b>  FFII PUMP OPS/HNA	<b>24</b>  FFI FE LECT	<b>25</b>  FFII PROPANE/FLAS H LECT	<b>26</b>  FFI FE DRILL	<b>27</b>	<b>28</b>  CEVO
<b>29</b>  HMA/HMO EXAM	<b>30</b>  FFII SURVIVAL	<b>31</b>  FFI FIRE CONTROL				

# April 26

SUNDAY	MONDAY	TUESDAY	WEDNESDAY	THURSDAY	FRIDAY	SATURDAY
			1 FFII SURVIVAL <b>OPEN FLASH</b>	2 FFI BDLG CONST	3 <b>GOOD FRIDAY</b>	4
5 <b>EASTER</b>	6 FFII SURVIVAL	7 FFI VENT LECT	8 FFII FLASH	9 FFI VENT DRILL	10	11 FFII ROPE RESCUE
12 FFI LADDER DRILL 2	13 FFII PROPANE PRACT.	14 FFI RESCUE LECT	15 <b>VALOR AWARDS</b>	16 FFI RESCUE DRILL	17	18 FFII DAY BURN
19 FFI SCBA DRILL 2	20 FFII FIRE CAUSE	21 FFI OPEN NIGHT	22 FFII FIRST AID	23 FFI SALVAGE	24	25  FFII OPEN DAY
26 FFI HNA DRILL 2	27 FFII OPEN NIGHT	28 FFI FIRE EXT.	29  <i>ICS-200</i>	30 FFI THERMAL/CAR FIRE		



# May 26

SUNDAY	MONDAY	TUESDAY	WEDNESDAY	THURSDAY	FRIDAY	SATURDAY
					1	2 <i>ICS-200</i>
3 FFI DAY BURN 1	4 FFI TECH RESCUE	5 FFI WILDLAND	6 FFII NIGHT BURN	7 FFI RESILIENCY	8 <i>BASIC PUMP</i>	9 <i>BASIC PUMP</i>
10 <b>MOTHERS DAY</b>	11 FFII TEST REVIEW	12 FFI NIGHT BURN	13 FFII EXAM	14 FFI WMD	15 <i>ROPE RESCUE 1</i>	16 <i>ROPE RESCUE 1</i>
			OPEN LIVE BURN			FFII VEHICLE EXTRICATION
17 <i>ROPE RESCUE 1</i>	18	19 FFI SPRINKLERS	20 <i>THERMAL IMAGINING</i>	21 FFI BBP	22	23
FFI CPR				<i>THERMAL IMAGINING</i>		
24	25 <b>MEMORIAL DAY</b>	26 FFI UTILITY	27	28 FFI HCN/BURNS	29 <i>FIRST DUE</i>	30 <i>FIRST DUE</i>
31 FFI DAY BURN 2						

# June 26

SUNDAY	MONDAY	TUESDAY	WEDNESDAY	THURSDAY	FRIDAY	SATURDAY
	<b>1</b> <b>RIC OPERATIONS</b>	<b>2</b> FF1 RIT/AUTISM	<b>3</b> <b>OPEN FLASH</b>	<b>4</b> FF1 PRACTICAL PREP	<b>5</b> <i><b>ADVANCE PUMP</b></i>	<b>6</b> <i><b>ADVANCE PUMP</b></i>
<b>7</b> FFI PRACTICAL EXAM	<b>8</b> <b>RIC OPERATIONS</b>	<b>9</b> FF1 TEST REVIEW	<b>10</b> <b>OPEN LIVE BURN</b>	<b>11</b> FF1 EXAM	<b>12</b> <i><b>ROPE RESCUE 2</b></i>	<b>13</b> <i><b>ROPE RESCUE 2</b></i>
<b>14</b>	<b>15</b> <b>RIC OPERATIONS</b>	<b>16</b>	<b>17</b> <b>RIC OPERATIONS</b>	<b>18</b>	<b>19</b> <i><b>FATHERS DAY</b></i>	<b>20</b> <b>RIC OPERATIONS</b>
<b>21</b>	<b>22</b> <b>RIC OPERATIONS</b>	<b>23</b>	<b>24</b> <b>RIC OPERATIONS</b>	<b>25</b>	<b>26</b>	<b>27</b> <b>RIC OPERATIONS</b>
<b>28</b>	<b>29</b> <b>RIC OPERATIONS</b>	<b>30</b>				

# July 26

SUNDAY	MONDAY	TUESDAY	WEDNESDAY	THURSDAY	FRIDAY	SATURDAY
			1	2	3	4 INDEPENDENCE DAY
5	6	7	8	9	10	11
12	13	14	15	16	17	18
19	20	21	22	23	24	25
26	27	28	29	30	31	

# August 25

SUNDAY	MONDAY	TUESDAY	WEDNESDAY	THURSDAY	FRIDAY	SATURDAY
					1	2
3	4	5	6	7	8	9
10	11	12	13	14	15	16
17	18	19	20	21	22	23
24	25	26	27	28	29	30
31						

## GENERAL INFORMATION

### PURPOSE

The purpose of this course announcement is to provide interested students of firefighting with important information about course offerings and the forms necessary for making application. All training will be conducted by, and at the facilities of, the Atlantic County Fire Training Center. Specific information on the content of each course offering is found in the pages that follow.

### PREREQUISITES

Firefighting courses are structured sequentially. For this reason, prerequisites have been established for many courses so that each student will have the necessary background to gain the most from each student area. Since many courses build upon the knowledge gained in the prerequisite courses, an unprepared student will not only fail to understand some of the material, they will also slow the progress of the entire class. Please note that prerequisites are indicated in the course description section for each Academy course. Make sure your personnel are qualified for that class.

If a person has taken a course that is a prerequisite for an Academy course from an institution other than the Atlantic County Fire Academy (ACFA), he or she must supply documentation of this at the time of application. Copies of certificates for these courses must accompany the course application in order to receive equivalency credit for that course.

### APPLICATION PROCEDURE

Personnel desiring to enroll into any course must do so through their respective Chief or Training Officer. All applications must be submitted at least 10 days prior to the commencement of the Class. **All information requested on the application must be provided for enrollment. The application will be returned if areas are left blank.** No walk-in will be accepted for any class that is not designated open enrollment. **A check or voucher must accompany each registration form.** Blank registration forms are in the back of this training announcement.

**A separate registration form for Firefighter 1 is required along with a completed Medical Form.** Both forms can be found in the back of this announcement.

## CONFIRMATION

No course confirmation will be sent to enrolled students. If the course is canceled or rescheduled for any reason, the contact person listed on the registration form will be contacted. It is the responsibility of the student and sending department to see that either the student or a replacement shows up for the scheduled class. No refunds will be given for registered students who fail to show up.

## CANCELLATION POLICY

If you have to cancel a person for some reason, you may cancel up to 14 days before the class. If you do not notify the Academy by that time, and the person or qualified replacement does not show up on the first day of the class, the tuition will **not** be refunded.

## REFUND POLICY

A refund of the course fee will be made for a student cancellation up to 14 days prior to the start of the course. Refunds cannot be made once the class starts including dropouts. If a course is canceled by the Academy for lack of student enrollment, all fees will be refunded.

## SUBSTITUTIONS

Should an accepted student discover that he/she would be unable to attend a course, a substitution may be possible. For a substitution request to be granted, the substitute must meet all of the prerequisites for the course. The substitute must attend the 1st class and notify the instructor of the substitution. **Failure to provide a substitute will forfeit tuition paid unless the Academy is notified within 14 days prior to the start of the course.**

## WALK IN REGISTRATION

Students wishing to register the first day of class may do so provided the class is not full. If you walk in and the class has already met its enrollment capacity, you will not be accepted. Walk-in registration will be on a first in basis with payment due prior to start of the class.

Unless otherwise noted, only open classes that do not have a maximum enrollment will be allowed to increase.

## PHYSICAL CONDITION OF STUDENTS

No student shall be admitted to class with any physical and/or other condition that would prevent them from safely participating in class activities. No student shall be given credit for any unit of instruction in which he or she did not or could not actively participate. Students who do not actively participate in any portion of the class will not be given a certificate of completion for the class and will not be eligible to return for other courses for which the completed course is a prerequisite.

All students participating in a class requiring the use of a SCBA will be required to sign a SCBA Mask Fit Certification Form found in the back of the booklet certifying that they are physical fit to take the class and have received a mask fit test in the last 12 months.

## FIRST SESSION REGISTRATION AND ATTENDANCE

Registration will be conducted at the first-class meeting of each course. For several courses, attendance at the first class is mandatory, for other classes, the first class may be missed, but only with advance permission from the Academy. Students who are not in attendance for mandatory first-class meeting or without prior approval to miss the first class will be dropped from the course. There will be no refunds for those who fail to attend the first session. Substitutions are allowed; refer to the section on "Substitutions".

Students are responsible to sign the roster for each lesson to receive credit for that lesson. Make-up students are responsible for signing the roster with their original class number, in order to receive credit. Please inform the instructor that you are making up a class from a previous course.

Students shall not leave the Academy prior to class dismissal without permission from the instructor in charge of the class.

## MAKE-UP POLICY

**Any students who have missed lessons/modules in Academy courses have two (2) year from the date the lesson was missed to make up the lesson.** This is especially important for Firefighter I and Firefighter II in which attendance of all modules is mandated by the State of NJ.

The procedure for make-ups will be as follows:

1. The student shall check the student handout to make sure of the date of the make-up class. For students making up Firefighter I or II classes, a copy of the semester schedule is provided in this announcement. Students should call 609-407-6743 to verify that the class has not been changed.

2. When signing the roster, each student shall print clearly his or her:
  - a. Full legal name
  - b. Fire Department/Company represented
  - c. Course number of the original class
  - d. Signature

## **DRESS CODES**

### **BEARDS & SELF-CONTAINED BREATHING APPARATUS**

In accordance with N.F.P.A. 1500: 5-3.10, “Standard on Fire Department Occupational Safety and Health Program”, and OSHA 29 CFR 1910.134, the Atlantic County Fire Training Center policy prohibits training individuals with facial hair that interferes with the mask seal on positive pressure self-contained breathing apparatus in those courses where SCBA must be worn. Those students with beards, or such facial hair **that does** interfere with the face-to-mask seal may **not** participate in some blocks of instruction and, therefore, cannot be given credit toward completion of those courses

### **PERSONAL PROTECTIVE EQUIPMENT**

Many of the courses offered at the ACFTC require each student to actively participate in actual firefighting evolutions, (live fire burns, and other practical evolutions). Each student involved in these training areas must provide and wear their own personal protective equipment (PPE). The academy cannot loan firefighters PPE to those improperly prepared. PPE shall include the complete and proper wearing of approved boots, turnout coat and pants, leather gloves, helmet, and eye protection, and Nomex or PBI hood. All this equipment must meet the NJ PEOSHA PPE requirements for firefighters.

The ACFTC will not be responsible for PPE or other department/company equipment damaged during training activities. Any reimbursement or replacement for damaged equipment should be submitted to the department/company's insurance company.

The wearing of jewelry by students to class is discouraged. Jewelry that can be removed **must** be removed and secured by the student prior to participating in outdoor activities. The ACFTC will not be responsible for lost jewelry.

### **SCBA USE**

In all courses/classes requiring the use of SCBA, it shall be the student's responsibility to bring a full spare cylinder with each SCBA. Please make sure that the SCBA and Cylinders are **MARKED** with your Department/Company identification prior to use at the ACFTC. All SCBA used must be properly.



Atlantic County Fire Academy  
5033 English Creek Avenue  
Egg Harbor Township, NJ 08234

hydrostatically tested. Any unit failing inspection will not be permitted to be used and the student will not be permitted to participate and will not be given credit for the class.

All students participating in training that puts them in an IDLH atmosphere must provide a signed **SCBA Mask Fit Certification Form** by their fire chief and bring it to the start of the course they are participating in. The Student Certification part of the form will be filled out prior to the start of the class in front of the lead instructor. A copy of the form is available in the back of this course announcement.

## **CERTIFICATE OF INSURANCE**

Each participating Department/Company must have current proof of liability and workmen's compensation insurance and indemnification on file at the ACFTC. Certificates can be sent to Director of Training, ACFTC, 5033 English Creek Avenue, Egg Harbor Township, NJ 08234-5743.

## **FINANCIAL RESPONSIBILITY FOR MEDICAL TREATMENT**

Any payment for any and all medical related charges will be the responsibility of the sponsoring organization or the student's fire department.

## **USE OF ATLANTIC COUNTY FIRE ACADEMY FOR LIVE BURN OPERATIONS**

Any fire company/department inside or outside Atlantic County may use the fire academy for live burn operations. The procedures are as follows:

1. Obtain any facility application from either the Atlantic County Firefighters' Association website, [atlanticcountyfireassoc.org](http://atlanticcountyfireassoc.org), or call 609-407-6752
2. Fill out the application picking two dates and times that you want to burn.
3. Submit the application to the fire academy by either fax at 609-407-6745 or mail to the address listed on the application.
4. The dates you requested will be checked for availability and you will be contacted if they are available.
5. **Due to the changes in NFPA 1403, Live Burn Standard, you will have to pay for 4 academy instructors to run your burn.**

**Atlantic County Fire Academy  
5033 English Creek Avenue  
Egg Harbor Township, NJ 08234**

6. You must also provide a dedicated EMT with a trauma bag, & defibrillator. If you do not have one, the academy will provide one at the instructor's cost.
7. The fee for using the burn building will be as follows:
  - a. In county: \$25.00 per hour per instructor, plus straw @ \$7.25 per bale.
  - b. Out - of - county: \$30.00 per hour, per instructor, plus straw @ \$7.25 per bale.
8. **Anyone inside the yellow line around the building MUST be in FULL PPE. This line is a safety zone 25' around the structure.**

## **OTHER SEMINAR OFFERINGS**

From time-to-time other seminars will be offered that are not listed in this bulletin. You will be notified by the Academy as to the dates and times as they become available.

## **FIREFIGHTER I: RULES AND REGULATIONS**

1. All evening classes start promptly on time at 7:00 p.m. All Saturday & Sunday classes start promptly at 8:30 a.m., unless otherwise specified.
2. Students will not leave class or drills prior to being dismissed.
3. All turn-out gear must fit properly, be free of rips and tears, and be PEOSHA approved as per P.L. 1983. Your gear will be inspected by your instructors for compliance.
4. Beards or excessive facial hair are not permitted. Anyone having such will not be permitted to attend firefighter I.
5. All classes are mandatory. You must attend. **NO EXCEPTIONS. In order to graduate Firefighter, I, you must make all classes and drills. If you miss any, you will have two years to make them up to receive a certificate of completion issued by the Fire Academy.** Failure to make it all in two years will result in restarting firefighter I from the beginning at the cost of \$350.00.
6. **Any student missing more than 10 classes must repeat the entire course and pay tuition of \$350.00.**
7. Any student missing SCBA Drill II & HNA Drill II will not be allowed to participate in any live fire evolutions.
8. **All radio pagers and cell phones shall be in the "off" position during class. Violations will result with phones being left on the front table.**
9. There is to be no food or drinks outside the cafeteria in classrooms or hallways. Water is an exception and may be taken into the classroom.

**Atlantic County Fire Academy  
5033 English Creek Avenue  
Egg Harbor Township, NJ 08234**

10. Students are responsible for maintaining any books, equipment, apparatus, or buildings made available for their use.
11. All students must be prepared for class and have any homework assignments completed. This also means bringing a pencil/pen and something to write on.
12. Students are required to police the classroom and training grounds at the end of each training session. This includes the area around your seat and to push your seat in under the table when you leave. These facilities must be left the way we found them.
13. Students must receive a 70% passing grade on final examination. Any student who fails the State exam will have two opportunities to take a make-up. The scheduling for such exam will be at the discretion of the Director of the ACFA.
14. Any student who has a learning disability is to notify the lead instructor or the Training Director.
15. There is to be absolutely no horseplay or disturbances in class or on the training grounds as this could lead to unsafe conditions and injury or possible dismissal from course.
16. Injuries of any nature incurred during training, either during class or on the drill-field, must be reported immediately to the Lead Instructor in charge or his staff. Accordingly, the respective Fire Chief will be notified.
17. Students will come dressed properly for class and training. No shorts, jeans, flip flops or open toe sandals. All students are required to wear their golf shirts during classroom presentations and their tee shirts during all outside training. Also, all students are to wear a dark blue or black pair of uniform pants with black boots. Students will be given one exception if not dressed properly, after that they will be asked to leave class. After a third violation they will be dismissed from class permanently. During drills, students are to come dressed properly but may wear their T-shirt. A fire company sweatshirt may be worn over T-shirts during cold weather.
18. No tobacco products will be permitted in any buildings and may be used only in areas designated by the instructors on the drill field.
19. Students must have a copy of their Municipalities Insurance Coverage on file with the Atlantic County Fire Academy.
20. The County of Atlantic has a “Zero Tolerance” policy on sexual harassment. Any student found breaking the policy will be dismissed from class permanently.

**Atlantic County Fire Academy  
5033 English Creek Avenue  
Egg Harbor Township, NJ 08234**

21. If anyone is suspected of being under the influence of alcohol or drugs, they will be removed from the classroom or training evolution. The ACFA has a “Zero Tolerance” policy. You will be given one violation. Two violations of this rule will result in dismissal from class.
22. No sleeping will be permitted during class. If you sleep, you will be required to make-up the class.
23. All students are to be familiar with the training cites, emergency exits, and the emergency evacuation signal during any hands-on training.
24. Please leave your attitudes and opinions at the door when you come in. You are here to learn how to be a firefighter. We know what we are doing, so just sit, be quiet, ask questions, and learn.

## **FIREFIGHTER I AGILITY TEST**

All firefighters who want to attend Firefighter 1 at the Atlantic County Fire Academy must pass an entrance test consisting of an agility test, ladder climb, and maze crawl. Below are two drawings of the agility test and maze crawl. Students will be notified on the first night of class when the agility test will be held. If you fail the agility test, you will be removed from class.

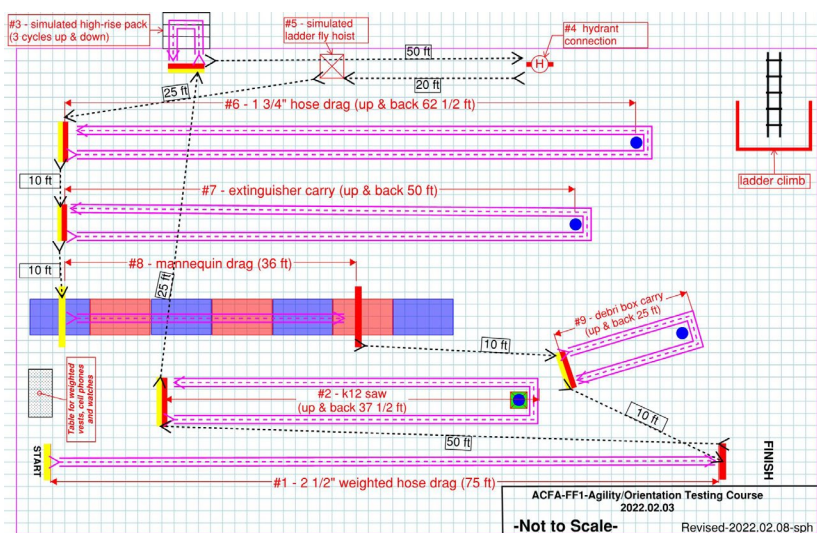

ACFA-FF1-Darkend Maze Crawl  
2022.02.03

**-Not to Scale-**

Revised-2022.02.10-sph

approx. 12 feet

approx. 21 feet

EXIT

ENTER

**Atlantic County Fire Academy  
5033 English Creek Avenue  
Egg Harbor Township, NJ 08234**

**Spring 2026 - Firefighter I Schedule – Full gear, SCBA and a piece of 10' 3/8 or 1/2 braided nylon rope are required to all classes.**

<b>Date</b>	<b>Class</b>	<b>Time</b>	<b>Lead Inst.</b>	<b>Notes</b>
<b>February</b>				
Thur. 2/19	Registration	7:00 - 10:00	Middleton	
Sun. 2/22	Agility Test & Fit Test	8:30 - 12:30	Staff	PT Clothes
Tues. 2/24	Orientation	7:00 - 10:00	Kislow	
Thurs. 2/26	Firefighter Safety	7:00 - 10:00	Graham	
<b>March</b>				
Sun 3/1	TIMS	8:30 - 4:30	Corbo	
Tues. 3/3	Fire Behavior	7:00 - 10:00	Corbo	
Thurs. 3/5	HNA Lect	7:00 - 10:00	Kislow	
Sun 3/8	HNA Drill 1	8:30 - 4:30	Kislow	
Tues 3/10	SCBA Lect.	7:00 - 10:00	Cahill	
Thurs. 3/12	SCBA Drill 1	7:00 - 10:00	Cahill	
Sun. 3/15	HMA	8:30 - 4:30	Corbo	
Tues. 3/17	Ladder Lect	7:00 - 10:00	Cahill	
Thurs. 3/19	Ladder Drill 1	7:00 - 10:00	Cahill	
Sun. 3/22	HMO	8:30 - 4:30	Corbo	
Tues 3/24	FE Drill	7:00 - 10:00	Merola	
Thurs. 3/26	FE Drill	7:00 - 10:00	Merola	
Sun. 3/29	Hazmat Exam	8:30 - 4:30	Middleton	
Tues. 3/31	Fire Control	7:00 -10:00	Corbo	
<b>April</b>				
Thurs. 4/2	Building Const	7:00 - 10:00	Cahill	
Tues. 4/7	Vent Lect	7:00 - 10:00	Grace	
Thurs. 4/9	Vent Drill	7:00 -10:00	Grace	
Sun. 4/12	Ladder Drill 2	8:30 - 4:30	Cahill	
Tues. 4/14	Rescue Lect	7:00 - 10:00	Moran	
Thurs 4/16	Rescue Drill	8:30 - 4:30	Moran	
Sun. 4/19	SCBA Drill 2	7:00 - 10:00	Cahill	
Tues. 4/21	Open Night	7:00 - 10:00	As Needed	
Thurs 4/23	Salvage	7:00 - 10:00	Libretti	
Sun. 4/26	HNA Drill 2	8:30 - 4:30	Kislow	

**Atlantic County Fire Academy  
5033 English Creek Avenue  
Egg Harbor Township, NJ 08234**

Tue.	4/28	Fire Ext	7:00 – 10:00	Kislow	
Thurs.	4/30	Thermal Balance	7:00 – 10:00	Winkler	
<b>May</b>					
Sun.	5/3	Day Burn 1	8:30 – 4:30	Kislow	
Tues.	5/6	Wildland	7:00 – 10:00	NJFFS	
Thurs.	5/7	Resiliency	7:00 – 10:00	Graham	
Tues.	5/12	Night Burn	7:00 - 10:00	Winkler	
Thurs.	5/14	WMD	87:00 – 10:00	Corbo	
Tues.	5/19	Sprinklers	7:00 – 10:00	Kislow	
Thurs.	5/21	BBP	7:00 - 10:00	Corbo	
Sun.	5/17	CPR	8:30 – 4:30	Zonge	
Tues.	5/26	Utility	7:00 – 10:00	Merola	
Thurs.	5/28	HCN/Burns	7:00 - 10:00	Macri	
Sun.	5/31	Day Burn 2	8:30 – 4:30	Winkler	
<b>June</b>					
Tues	6/2	RIT/Autism	7:00 – 10:00	Winkler	
Thurs.	6/4	Practical Prep	7:00 - 10:00	Graham	
Sun.	6/7	Practical Exam	8:30 – 4:30	<u>Winkler</u>	
Thurs	6/9	Test Review	7:00 – 10:00	Corbo	
Tues	6/11	Written Exam	7:00 – 10:00	Middleton	



**Atlantic County Fire Academy  
5033 English Creek Avenue  
Egg Harbor Township, NJ 08234**

**Spring 2026 - NJ Firefighter II Program Schedule – Full gear and SCBA are require for all classes.**

<b>March</b>					
Mon.	3/9	Registration, Report Writing & Communications	7:00 - 10:00	Corbo	
Wed.	3/11	Building Construction	7:00 – 10:00	Cahill	

Mon.	3/16	Advance Vent	7:00 – 10:00	Grace	
Wed.	3/18	Foam Ops	7:00 - 10:00	Corbo	
Sat.	3/21	Foam Ops/Testing	8:30 – 4:30	Ward	
Mon.	3/23	Pumps/HNA	7:00 – 10:00	Corbo	
Wed.	3/25	Propane Flash Lect	7:00 – 10:00	Corbo	
Sat	3/28	CEVO	8:30 – 4:30		
Mon	3/30	Survival	7:00 – 10:00	Winkler	
<b>April</b>					
Wed.	4/1	Survival	7:00 - 10:00	Winkler	
Mon.	4/6	Survival	7:00 – 10:00	Winkler	
Mon.	4/8	Flashover	7:00 – 10:00	Staff	
Sat	4/11	Rope Rescue	7:00 – 10:00	Winkler	
Mon.	4/13	Propane Pract.	7:00 – 10:00	Winkler	
Mon.	4/16	Rescue Drill	7:00 - 10:00	Moran	
Sat.	4/18	Day Burn	8:30 – 4:30	Winkler	Spare Cylinder
Mon.	4/20	Fire Cause	7:00 – 10:00	Moran	
Wed.	4/22	First Aid	7:00 – 10:00	Taylor	
Sat.	4/25	Open Day	8:30 – 4:30	Staff	
Mon	4/27	Open Night	7:00 – 10:00	Staff	
Wed.	4/29	ICS-200	7:00 – 10:00	Corbo	
<b>May</b>					
Sat.	5/2	ICS-200	8:30 – 4:30	Corbo	
Mon.	5/4	Tech Rescue	7:00 – 10:00	Winkler	
Wed.	5/6	Night Burn	7:00 - 10:00	Winkler	
Mon.	5/11	Test Review	7:00 – 10:00	Kislow	
Sat.	5/16	Vehicle Extrication	8:30 – 4:30	Macri	
Mon.	5/18	Written Exam	7:00 – 10:00	Middleton	

## **FIREFIGHTER I (Tuesday & Thursday & Sundays)**

***Course #: FFI – S26***

This Firefighter I program will provide the training necessary to attain the minimum basic skills the firefighter must have to safely perform duties at the entry level. This program meets the requirements of the New Jersey Division of Fire Safety for Firefighter Level I under N.J.A.C. 5:18C and follows the N.F.P.A. 1001. NJ State Police Hazardous Materials Awareness and Operations, NJ Department of Health Blood Borne Pathogens, NJ Forest Fire Service's Basic Ground Cover Fires, Critical Incident Stress, CBRNE Awareness & Operations, Incident Command System I-100 & 700, Autism & RIT Awareness, SCBA Mask Fit test, & CPR for the Professional Rescuer classes are included in this program.

**PREREQUISITE: At least 18 years of age and an active member of an organized fire department.**

Class Limit: **(30 students)**  
Location: Fire Training Center

Class Hours: 200  
**Fee: In County: Free\***  
**Out of County: \$350.00\***

**Date: February 19 through June 11, 2026**

Tuesdays & Thursdays: (7:00 - 10:00 PM.)

Sundays: (8:30 - 4:30 PM)

Instructors: Staff

**\*(Out of county tuition includes Class Golf & T- shirts, In-county must pay \$30.00,  
All students must pay \$40.00 for CPR if not already certified)**

### **FULL PPE REQUIRED FOR ALL CLASSES.**

\*\*\*\*\*

## **FIREFIGHTER II (Monday & Wednesday & Saturdays)**

***Course #: FFII - S26***

This firefighter II program is based on the new curriculum adopted by the NJ Division of Fire Safety. It will provide the Firefighter I student with the necessary training to increase his firefighter skills. A large majority of the course is devoted to practical exercises in the areas of firefighter survival, rope rescue, advanced search & rescue, propane firefighting, vehicle extrication, basic first aid, technical rescue support, and other fire ground activities.

**PREREQUISITE: Firefighter Level I.**

Class Limit: **(30 Students)**  
Location: Fire Training Center

Class Hours: 90  
**Fee: \$375.00**

**Date: March 9 through May 18, 2026**

Mondays and Wednesdays: (7:00 - 10:00 PM)

Saturdays: (8:30 AM - 4:30 PM)

Instructors: Staff

### **FULL PPE REQUIRED FOR ALL CLASSES.**

**YOU MUST BRING A COMPLETED SCBA FACE FIT CERTIFICATION FORM. (SEE END OF THIS BOOK FOR FORM)**

## **BASIC PUMP OPERATIONS**

*Course #: BP - S26*

This course has been re-designed and updated. It will train firefighters in basic pump theory, hydraulic calculations, apparatus placement, types of pumps, and the duties of the pump operator. The course combines classroom and hands-on evolutions that include the fundamentals of fire ground pump operations, drafting, and hydrant hookups.

**PREREQUISITE: Firefighter Level I- or 5-years' experience in an organized fire department.**

Class Limit: 30 Students  
Minimum required is 10  
Location: Fire Training Center

Class Hours: 11  
**1st Class Mandatory**  
**Fee: \$90.00** (Lunch included Saturday)

**Date: May 8 & 9, 2026**  
Friday: (7:00 - 10:00 PM)  
Saturday: (8:30 AM - 4:30 PM)

Lead Instructor: Michael Corbo  
Director (Ret), Atlantic County Fire  
Academy  
Deputy Chief (Ret), Pleasantville FD,

## **FULL PPE REQUIRED FOR OUTSIDE EVOLUTIONS**

\*\*\*\*\*

## **ADVANCED PUMP OPERATIONS**

*Course #: AP - S26*

This course has been re-designed and updated. It will lead off where basic pump stopped and will continue to train the firefighter in pump operations. The course combines classroom and hands-on evolutions to include standpipe operations, relay pumping, water shuttle operations with portable ponds, supplying master streams, and large diameter hose.

**PREREQUISITE: Basic Pump Operations**

Class Limit: 30 Students  
Minimum required is 10  
Location: Fire Training Center

Class Hours: 11  
**1st Class Mandatory**  
**Fee: \$90.00** (Lunch included Saturday)

**Date: June 5 & 6, 2026**  
Friday: (7:00 - 10:00 PM)  
Saturday: (8:30 AM - 4:30 PM)

Lead Instructor: Michael Corbo  
Director (Ret), Atlantic County Fire  
Academy  
Deputy Chief (Ret), Pleasantville FD,

## **FULL PPE REQUIRED FOR OUTSIDE EVOLUTIONS**

## **SIZING UP THE INCIDENT**

**Course #: SZ- S25**

“A picture is worth a thousand words.” The initial report and scene size up should paint this picture for all responding units without using a thousand words. Every emergency scene requires a size up, the fire ground, EMS scene and the hazardous materials incident.

**Saturday:** The class will cover the various components of the scene size up and to what level each factor can or will impact an incident, giving the students the tools to paint an accurate and compressive picture.

1. What have I got?
2. Where is it going and what can I do about it?
3. What do I need?

Both segments of the class will highlight the evolving scene dynamics of the fire ground and the need for the continual size up process.

**PREREQUISITE:** Firefighter Level I & the desire to operate on a safe fire ground through critical observations.

Class limit: 30

**Class minimum: 10**

Location: Fire Training Center

**Date: March 14, 2026**

Class Hours: 8

**Fee: \$45.00**

Lead Instructor Michael Cahill, Fire Chief  
Ventnor City Fire Department

## **WEDNESDAY NIGHT LIVE BURN FIREFIGHTING**

*Course #: WLB-S-26*

To meet the growing demand for live fire training, the Atlantic County Fire Academy will offer live fire training on the first Wednesday night of each month starting in April through June during the Spring Semester and September through November in the Fall Semester, weather permitting. The type of burn evolution (basement, attic, multi room, etc.) will be determined by the instructors and students attending the training.

The class will be limited to 12 firefighters each night. Anyone wishing to participate will need to **pre-register**.

**PREREQUISITE: NJDFS Firefighter I Certification.**

Class Limit: 12 Students

Class Hours: 3

**Class Minimum: 6 Students**

Location: Fire Training Center Burn Bldg

**Fee: \$55.00**

Wednesday: (7:00 - 10:00 PM)

Instructors: Staff

**Dates:**

**March 11, 2026**

**May 07, 2026**

**June 10, 2026**



All participants should arrive by at least 6:45 p.m. You must now pre-register for this class. If there are not enough students signed up, the **class will be cancelled**. All registered students will be notified prior to Wednesday night if class is cancelled.

**FULL PPE, SCBA AND SPARE CYLINDER REQUIRED FOR ALL EVOLUTIONS**

**YOU MUST BRING A COMPLETED SCBA FACE FIT CERTIFICATION FORM. (SEE END OF THIS BOOK FOR FORM**

## **FLASHOVER AWARENESS & SIMULATOR**

*Course #: FOS\_\*S-26*

The Atlantic County Fire Academy is excited to be able to deliver one of the premier training experiences that provides firefighters with the best live fire training program currently available to the fire service.

The Simulator known as the “Can” is a laboratory, designed to provide firefighters with a safe and secure system to recognize the signs of a flashover. The burning of Class "A" combustibles will take place in the burn chamber, located three feet off the ground. Firefighters will be able to witness fire growing from an incipient stage to flashover conditions. As the combustibles burn, the interior instructors will have the ability to control the conditions inside the simulator through the combined use of ventilation and "penciling of water." It is through this management that firefighters can experience a safe observation of a flashover. Students will attend classroom instruction prior to entering the simulator.

Key points of the system include incipient phase of the fire, fire growth, smoke production, high- and low-pressure zones, thermal feedback, rollover and then flashover. The students are shown. There can be multiple flashovers before the fuel load is depleted.

### **PREREQUISITE: NJDFS Firefighter Level I Certification**

Class Limit: 12 Students

Class Hours: 3

**Class minimum: 8**

Location: Fire Training Center

**Fee: \$65.00**

Monday - Friday: (7:00 - 10:00 PM)

Instructors: ACFA Staff

Atlantic County Fire Academy  
5033 English Creek Avenue  
Egg Harbor Township, NJ 08234

## **BASIC ROPE RESCUE**

**Course: BRR-S26**

At the request of many previous students, this course was developed by our instructors to provide a foundation in safe operating principles and practices in rope rescue operations. Utilizing many of the rope programs in use today we were able to design a class meeting all the required standards and operations. This 20-hour course will instruct the students in basic knot tying, equipment identification and use, rappelling, stokes basket operations, mechanical advantage. Students will spend time learning the necessary operations, then apply the operations during simulated incidents. Class split over two weekends to give students time to spend with their families not tying up a whole weekend.

**PREREQUISITE:** Firefighter Level I- or 5-years' experience in an organized fire department.

Class Limit: 20

Class Hours: 20

**Class Minimum: 12**

**Fee: \$175.00** (includes Lunch on Saturday)

Location: Fire Training Center

Date: May 15, 16 & 17, 2026

Lead Instructor: Chief Charles Winkler,

Friday: (7:00 - 10:00 pm)

EHT Fire Department

Saturday & Sunday: (8:30 am - 4:30 pm)

Students will need to bring gloves, hard hat/helmet, and work boots to class.

\*\*\*\*\*

## **ROPE RESCUE II**

**Course #: RRII-S26**

At the request of many previous students, this course was developed by our instructors to continue rope rescue training from the Basic Rope Rescue course. This 20-hour course will instruct the students in self-rescue, rescuing victims using pickoffs while rappelling, anchor systems, line transfers, advanced mechanical advantage. Students will spend time learning the necessary operations, then apply the operations during simulated incidents. Class split over two weekends to give students time to spend with their families not tying up a whole weekend.

**PREREQUISITE: Basic Rope Rescue or Rope Rescue I**

Class Limit: 20

Class Hours: 20

**Class Minimum: 12**

**Fee: \$175.00** (includes Lunch on Saturday)

Location: Fire Training Center

Date: June 12, 13 & 14, 2026

Lead Instructor: Chief Charles Winkler

Friday: (7:00 - 10:00 pm)

EHT Fire Department

Saturday & Sunday (8:30 – 4:30)

## **First Due: Initial Company Operations on the Fireground**

***Course #: ICOF-S26***

**Class Description:** The initial actions of the first arriving crew can make or break the incident. This class will allow firefighters to gain confidence in their abilities through the use of live-fire scenarios and hands-on training. Items that will be included in this class are: size-up, hose line stretches, hose line advancement, forcible entry, ground ladder deployment, searching, and victim removal. Participants will be given the opportunity to practice these skills prior to being put into real-world live fire scenarios during the second half of the class.

**Audience:** Any Firefighter I trained, SCBA qualified member of a fire department.

**FULL PPE, SCBA AND SPARE CYLINDER REQUIRED THIS COURSE.**

**Class minimum: 10**

Location: Fire Training Center

Classroom: Drill Ground

**Date: May 29 & 30, 2026**

Friday (7:00-10:00pm)

Saturday (8:30 am - 4:30 pm)

**Class Hours 8**

**Fee: \$125.00 (includes lunch)**

Lead Instructor: Casey Hunt,  
Pleasantville Fire Department

\*\*\*\*\*

## **NJ DIVISION OF FIRE SAFETY PROGRAMS**

### **I-200: BASIC ICS**

***Course # ICS I-200-S26***

The 12-hour Incident Command System I-200.c course consists of the following topics in accordance with the NIMS (NJDFS requirement for Level 1 IMS Certification): Leadership and management; delegation of authority; management by objectives; functional areas and positions; briefings; organizational flexibility and transfer of command

**PREREQUISITE: IS-700b and I-100c**

**Class minimum: open**

Location: Fire Training Center

**Date: April 29 & May 2, 2026,**

Wednesday: (7:00 - 11:00 PM)

Saturday (8:30 – 4:30 PM)

Class Hours: 14

**Fee: In County Free**

**Out of County: \$40.00**

Lead Instructor: Michael Corbo  
Director (Ret), Atlantic County Fire  
Academy  
Deputy Chief (Ret), Pleasantville FD,



Atlantic County Fire Academy  
5033 English Creek Avenue  
Egg Harbor Township, NJ 08234

**THERMAL IMAGING**

**Course # TI-S26**

This class is an introduction course to basic uses of thermal imaging in the Fire Service. This course will cover understanding thermal imaging, thermal camera use in fire attack, search & rescue, hazardous materials, and wild land fires. Participants will learn how Thermal Imaging Cameras work, different options and learn common mistakes made by Fire Fighters when using Thermal Imaging Cameras and how they commonly get into trouble with our new technology.

Wednesday: Classroom instruction includes thermal imaging theory, basic operation of different TI cameras, and thermal signature interpretation.

Thursday: Outside Evolutions include Search & Rescue; HAZMAT; and Fire Attack.

**PREREQUISITE: Firefighter Level I or 5 years' experience in an organized fire department.**

Class limit: 16

Class Hours: 6

Class minimum: 10

Location: Fire Training Center

**Fee: \$ 55.00**

**Dates: May 20 & 21 2025**

Wednesday & Thursday: (7:00 - 10:00 pm)

Lead Instructor: Christopher Kislow,  
Lieutenant, Pomona Fire Co.

**FULL PPE, SCBA AND SPARE CYLINDER REQUIRED FOR ALL  
EVOLUTIONS – ONLY NEEDED FOR THURSDAY CLASS**

**YOU MAY BRING YOUR COMPANIES THERMAL CAMERA WITH A  
LETTER FROM YOUR CHIEF, STATING YOU CAN USE IT IN THIS**

## **NEW COURSE**

### **RAPID INTERVENTION CREW**

**Course # RIC-S26**

This new course is designed to meet the requirements of the New Jersey Division of Fire Safety Rapid Intervention Regulations and is based on the NFPA 1407 standard and the J & B manual, "Fire Service Rapid Intervention Crews". The successful rescue of a lost, trapped or missing firefighter requires a significant amount of skill, preparation, and effort. History has proven that a lack of preparation and training in handling these types of emergencies continually hampers the RIC's operations towards a successful outcome.

This 37-hour course includes 50 skills that will provide you and your emergency response organization with the tools to develop or enhance your rapid intervention team programs. This course will cover the RIC concept, duties and responsibilities, problems on the fireground that require the RIC activation, methods of firefighting self-rescue, RIC equipment and tool cache, basic rope rescue operations and knots, calling a "MAYDAY" and giving a status report. Firefighter rescue skills will include: The "NANCE" Drill, the "DENVER" drill, Below - Grade firefighter rescue, Upper floor firefighter removal, Window removal, Individual rescue drags and carries, Rope Assisted Search techniques, SCBA/Air management techniques, Ladder slide and emergency escape, and Communications.

**NOTE:** This course will involve VERY STRENUOUS ACTIVITIES. All students will be required to complete all modules of RIC training and the passage of the State exam for completion of course. There will be NO exceptions. Students with successful completion will receive the NJDFS RIC Member certification. Students who also possess a NJDFS Fire Officer I certification will also receive a NJDFS RIC Officer certification.

**PREREQUISITE:** NJ Firefighter I certification

Class Limit: 16

Class Minimum: 10

Location: Fire Training Center

Class Hours: 37

Fee: **\$425.00** (includes Book and lunch on Saturday)

**Date: June 1, 8, 15, 17, 20, 22, 24, 27, 29, 2026**

Monday & Wednesday: (7:00 - 10:00 pm)

Director, ACFA

Saturday: (8:30 am - 4:30 pm)

Committee.

Lead Instructor: Michael Corbo, Retired

Program Chair, NJDFS RIC SME

**FULL PPE, SCBA AND SPARE CYLINDER REQUIRED FOR ALL PRACTICAL EVOLUTIONS**

.....

**Atlantic County Fire Academy  
5033 English Creek Avenue  
Egg Harbor Township, NJ 08234**

**REGISTRATION FORM - FIREFIGHTER I**

PLEASE PRINT OR TYPE THE FOLLOWING INFORMATION

Spring \_\_\_\_ Summer \_\_\_\_ Fall \_\_\_\_

STUDENT'S FULL NAME: \_\_\_\_\_

First

Middle

Last

HOME ADDRESS: \_\_\_\_\_

City

County

State

Zip

HOME TELEPHONE #: (\_\_\_\_) \_\_\_\_\_ CELL PHONE #: (\_\_\_\_) \_\_\_\_\_

DATE OF BIRTH: \_\_\_\_/\_\_\_\_/\_\_\_\_, AGE: \_\_\_\_\_, SS #: \_\_\_\_/\_\_\_\_/\_\_\_\_

DRIVER'S LICENSE #: \_\_\_\_\_ **DFS Number** \_\_\_\_\_

T-SHIRT SIZE: \_\_\_\_\_, GOLF SHIRT SIZE: \_\_\_\_\_, Email Address: \_\_\_\_\_

EDUCATION: HIGHEST GRADE LEVEL COMPLETED \_\_\_\_\_

FIRE COMPANY NAME: \_\_\_\_\_

FIRE COMPANY ADDRESS: \_\_\_\_\_

FIRE COMPANY TELEPHONE #: (\_\_\_\_) \_\_\_\_\_ FAX #: (\_\_\_\_) \_\_\_\_\_

Medical Form Attached: Yes \_\_\_\_ No \_\_\_\_ Date: \_\_\_\_\_

**NOTE: Attach a copy of a completed and signed medical form to this registration form.  
Forms can be found in the current course announcement.**

Check, money orders, or company vouchers are to be made payable to the **Atlantic County Fire Academy** and mailed to the above address.

The applicant has read this form and by his/her signature agrees to abide by the regulations and age requirement of 18 established by the Atlantic County Firefighters' Association.

\_\_\_\_\_  
Signature of Applicant

\_\_\_\_\_  
Date

**CERTIFICATION**

I, \_\_\_\_\_, \_\_\_\_\_ of  
Print Name Title

\_\_\_\_\_, do hereby certify that the information contained in  
Company/Department  
this registration form is true and accurate. I also confirm that the applicant is covered by a  
Worker's Compensation Insurance Policy.

\_\_\_\_\_  
Signature of above Fire Chief or his Designee

\_\_\_\_\_  
Date

Atlantic County Fire Academy  
5033 English Creek Avenue  
Egg Harbor Township, NJ 08234

**MEDICAL FORM – FIREFIGHTER I**

To be filled out by a physician licensed in the State of New Jersey and returned with the Firefighter I Registration Form. Physical examination guidelines and Firefighter Performances are listed below. All sections of the physical must be properly filled out or the application will be returned.

PLEASE PRINT

NAME: \_\_\_\_\_  
                    First                                Initial                                Last                                Sex

Age: \_\_\_\_\_ Height: \_\_\_\_\_ Ft. \_\_\_\_\_ In. Weight: \_\_\_\_\_ lbs. Hearing: \_\_\_\_\_

Eyesight Left: \_\_\_\_\_ Right: \_\_\_\_\_ Both (corrected): \_\_\_\_\_ BP: \_\_\_\_\_

**PHYSICAL EXAMINATION GUIDELINES**

1. **EYES:** Must be 20/30 corrected (with glasses, contacts, or surgical procedures)
2. **HEARING:** Loss of hearing acuity so as to be unable to perceive sounds within normal voice range with or without hearing aid.
3. **NOSE:** Any significant nasal obstruction to free breathing not subject to correction by surgery.
4. **MOUTH:** Conditions with impair ability to communicate.
5. **NECK:** Problems resulting from (a) Goiter; (b) Limited range of motion; which prohibits range of motion, extension or free movement of neck; (c) Tracheotomy – existing openings at the lower portion of the neck connecting the windpipe to the outside environment for the purpose of easy breathing.
6. **PULMONARY:** Problems resulting from loss or removal of lung: (a) any pulmonary disorder which would limit the applicants ability to perform; (b) Pulmonary function test below normal; (c) Chronic Obstructive Pulmonary Disease/Asthma.
7. **CARDIO PULMONARY SYSTEM:** Problems resulting from heart disease or cardiomegaly.
8. **PERIPHERAL VASCULAR SYSTEM:** Problems resulting from: (a) Varicose veins; (b) Aneurysms; (c) Lymph edema; (d) Thrombophlebitis; (e) Arteriosclerosis Obliterans; (f) Buerger's Disease; (g) Raynaud's Disease; (h) Arterio-Venous Fistula; (i) High Blood Pressure, not able to be corrected or controlled by medication. Acceptable blood pressure reading should be as follows: Systolic not higher than 150 but not lower than 90. Diastolic maximum should be 100 mmhg, minimum 50 mmhg.
9. **ABDOMEN:** Problems resulting from a (a) Organomegaly; (b) Signs of tenderness in an area; (c) Presence of masses such as hernias of various types.
10. **GENITOURINARY SYSTEM:** Problems arising from (a) Presence of abnormal masses; (b) Abnormal discharges from any of the orifices; (c) Active venereal diseases; (d) Parasitic diseases; (e) Varicocele and Varices; (f) Hydrocele.
11. **MUSCULO-SKELETAL SYSTEM:** Problems arising from (a) Congenital malformation; (b) Limitation of Motion; (c) Weakness; (d) Impairment or absence of one or more of the digits on either or both hands; (e) Impairment of function of the hands; (f) Missing toes if it interferes with ambulation; (g) Deformities of the spine, pelvis or extremities.
12. **OTHERS:** Problems arising of (a) Disqualification for psychiatric conditions must be determined by local agencies; (b) Allergic conditions which are chronic and incapacitating; (c) Severe anemia; (d) Active Peptic Ulcer; (e) Diabetes; (f) History

Atlantic County Fire Academy  
5033 English Creek Avenue  
Egg Harbor Township, NJ 08234

**MEDICAL FORM - FIREFIGHTER I**

of epilepsy or seizures other than documented febrile convulsions in childhood; (g) alcoholism or drug addiction; (h) Removal of vital organs; (i) Any other condition not listed above which would render the eligible incapable of performing their duties as a firefighter.

THESE MEDICAL GUIDELINES ARE TO BE FOLLOWED BY THE PHYSICIAN PERFORMING THE EXAMINATION. ANY ABNORMAL FINDINGS THAT WOULD PROHIBIT THE APPLICANT FROM OPERATING IN A SAFE MANNER OR PERFORMING ANY OF THE LISTED PERFORMANCES ARE GROUNDS FOR THE APPLICANT TO BE REJECTED.

**FIREFIGHTER PERFORMANCIES**

The following are a list of job performances that will be performed by the applicant during his/her training and throughout the course of his/her firefighting career.

1. Ability to raise, climb and work off of ladders above the ground.
2. Ability to wear a Self-Contained Breathing Apparatus (SCBA) and operate in an IDLH atmosphere including smoke and high heat environments.
3. Ability to work in a vision obscured environment.
4. Ability to hold and handle a charged hose line during extinguishment of a fire.
5. Ability to hold and handle hand tools, power tools and power saws during forcible entry, ventilation and firefighting operations.
6. Ability to crawl, walk, lift heavy objects and work in a stress-induced environment while wearing protective clothing and equipment weighing approximately 50 lbs.
7. Ability to hear radio transmission and perform two-way communication.
8. Ability to rescue and lift civilian victims and other firefighters in need of help.

I CERTIFY AS A PRACTICING PHYSICIAN IN THE STATE OF NEW JERSEY, THE APPLICANT IS FREE FROM ANY ACUTE OR CHRONIC DISEASE AND HAS NO PHYSICAL DEFECTS THAT WOULD HINDER HIS/HER ABILITY TO PERFORM THE DUTIES OF A FIREFIGHTER.

DATE EXAMINED \_\_\_\_\_ EXAMINED AT \_\_\_\_\_

\_\_\_\_\_  
PHYSICIAN'S PHONE NUMBER

\_\_\_\_\_  
PRINT PHYSICIAN'S NAME

\_\_\_\_\_  
SIGNATURE OF PHYSICIAN

**Atlantic County Fire Academy  
5033 English Creek Avenue  
Egg Harbor Township, NJ 08234**

**Directions:**

- 1.) Print your name and fire company and have your Fire Chief sign the Certification below prior to you participating or attending any live fire evolution or IDLH atmosphere requiring the use of a SCBA at Atlantic County Fire Academy.
- 2.) **Do not** fill out the rest of this form at this time. Bring it with you to the Fire Academy. The Lead Instructor at the Fire Academy will instruct you when to complete it.

**FIRE CHIEF CERTIFICATION**

\_\_\_\_\_  
Name of Firefighter

\_\_\_\_\_  
Name of Fire Company

The above firefighter has received and passed a SCBA Mask fit test and the results allow him/her to wear an SCBA during firefighting operations and IDLH Atmospheres.

Date: \_\_\_\_/\_\_\_\_/\_\_\_\_

\_\_\_\_\_  
Signature of Fire Chief/Authorized Designee

**STUDENT/PARTICIPANT CERTIFICATION**

I \_\_\_\_ of \_\_\_\_  
(Print your Name) (Name of Fire Company)

hereby certify that I have received and passed at SCBA mask fit test in the last 12 months and that the SCBA Mask that I will be using during the live fire training today is the type and size that I was fit tested with.

I further certify that I understand that standing up in a live fire evolution may result in me receiving burns to my body.

I further certify that I have no known medical problem or medication that would prevent me from participating in any live fire evolution or IDLH atmosphere.

Date: \_\_\_\_/\_\_\_\_/\_\_\_\_

\_\_\_\_\_  
Signature of Student/Participant

\_\_\_\_\_  
Type of Training

\_\_\_\_\_  
Lead Instructor Signature

## **To obtain access to the NJ DFS certification and Registration portal (without an existing FFID#)**

### **Confirm or create a login at nj.gov for myNJ.**

1. Go to nj.gov
2. Log into your existing myNJ account. If you do not have one, create it now.
3. After confirming your myNJ
4. If you have access to the NJ DFS certification Portal go to the Portal via myNJ. If you do not have access, you must complete the sign-up process below.

### **How to link the DFS Portal to your myNJ.**

1. Access the portal registration site at the link shown.  
[https://certification.dca.nj.gov/NJDCA\\_cert\\_Lice\\_Portal](https://certification.dca.nj.gov/NJDCA_cert_Lice_Portal)
2. Click the sign-up button on the upper right side of the page.
3. Answer NO, as you DO NOT have a DFS ID.
4. Enter your information as directed.
5. Click the blue register account Bar.
6. The system will ask if you have a myNJ, answer yes as you should have already confirmed or created one.
7. Log into your myNJ.
8. You will be sent a verification email, click the link to complete the process.
9. Log into your myNJ, you will have an icon to access the DCA Cert and Reg Portal.
10. Choose the Request DFS ID, or Request Firefighter ID#.
11. You will receive an email when your number has been issued, this may take up to 24 hours.
12. After your ID# is issued, you will receive certificates via the portal, you will also apply for certifications via the portal.

### **Future access is through your myNJ account.**

**PLEASE PRINT ALL INFORMATION CAREFULLY**

<b>PRE-REGISTRATION FOR:</b>	<b>DATES OF COURSE:</b>
<b>PREREQUISITES:</b>	<b>ATTACH COPIES OF CERTIFICATES</b>
<b>COURSE #:</b>	<b>RETURN BY: 10 DAYS PRIOR TO START OF CLASS</b>

	LAST NAME	FIRST NAME	MI	SOCIAL SECURITY	PHONE NUMBER
1.					
2.					
3.					
4.					
5.					
6.					

**Dress:** CLASS ROOM: CASUAL

**CUTOFFS or SHORTS NOT PERMITTED**

DRILL FIELD: FULL PPE & SCBA WHEN NECESSARY

WE CERTIFY THAT THE STUDENTS LISTED ABOVE DO NOT HAVE ANY PHYSICAL AND/OR OTHER CONDITIONS THAT WOULD PREVENT THEM ACTIVELY PARTICIPATING IN ALL PORTIONS OF THIS COURSE. WE UNDERSTAND THAT PAYMENT FOR ANY MEDICAL, FIRST AID, DAMAGED EQUIPMENT, AND RELATED CHARGES WILL BE THE RESPONSIBILITY OF THE SPONSORING ORGANIZATION. SUBMISSION OF A SIGNED APPLICATION AUTOMATICALLY INDICATES COMPANY/DEPARTMENT AGREES TO POLICIES OUTLINED IN COURSE PUBLICATION.

<b>FIRE DEPT/CO OR OTHER SPONSORING ORGANIZATION: PRINT CLEARLY</b>	
NAME: _____	
ADDRESS: _____	
(Please include on all registration forms, No Exceptions)	
THE ABOVE CONDITIONS ARE UNDERSTOOD AND STUDENTS ATTENDING ARE AUTHORIZED BY:	PRINT SIGNATURE:
AUTHORIZED SIGNATURE                      DATE:	TITLE:
FORM OF PAYMENT: CO. CHECK _____ CO. VOUCHER/PO _____ PERSONAL CHECK _____ IN THE AMOUNT OF \$ _____ IS ATTACHED	PHONE: (WORK) (     ) _____ PHONE: (HOME) (     ) _____ STATION:            (     ) _____ FAX                    (     ) _____
PAYMENT IS REQUIRED WITH SUBMISSION OF THIS REGISTRATION FORM. REFUNDS WILL BE MADE ACCORDING TO POLICIES OUTLINED IN COURSE PUBLICATION.	



**PLEASE PRINT ALL INFORMATION CAREFULLY**

<b>PRE-REGISTRATION FOR:</b>	<b>DATES OF COURSE:</b>
<b>PREREQUISITES:</b>	<b>ATTACH COPIES OF CERTIFICATES</b>
<b>COURSE #:</b>	<b>RETURN BY: 10 DAYS PRIOR TO START OF CLASS</b>

1.	LAST NAME	FIRST NAME	MI	SOCIAL SECURITY	PHONE NUMBER
2.					
3.					
4.					
5.					
6.					

**Dress:** CLASSROOM: CASUAL

**CUTOFFS or SHORTS NOT PERMITTED**

DRILL FIELD: FULL PPE & SCBA WHEN NECESSARY

WE CERTIFY THAT THE STUDENTS LISTED ABOVE DO NOT HAVE ANY PHYSICAL AND/OR OTHER CONDITIONS THAT WOULD PREVENT THEM ACTIVELY PARTICIPATING IN ALL PORTIONS OF THIS COURSE. WE UNDERSTAND THAT PAYMENT FOR ANY MEDICAL, FIRST AID, DAMAGED EQUIPMENT, AND RELATED CHARGES WILL BE THE RESPONSIBILITY OF THE SPONSORING ORGANIZATION. SUBMISSION OF A SIGNED APPLICATION AUTOMATICALLY INDICATES COMPANY/DEPARTMENT AGREES TO POLICIES OUTLINED IN COURSE PUBLICATION.

<b>FIRE DEPT/CO OR OTHER SPONSORING ORGANIZATION: PRINT CLEARLY</b>	
NAME: _____	
ADDRESS: _____ (Please include on all registration forms, No Exceptions)	
THE ABOVE CONDITIONS ARE UNDERSTOOD AND STUDENTS ATTENDING ARE AUTHORIZED BY:	PRINT SIGNATURE:
AUTHORIZED SIGNATURE                      DATE:	TITLE:
FORM OF PAYMENT: CO. CHECK _____ CO. VOUCHER/PO _____ PERSONAL CHECK _____ IN THE AMOUNT OF \$ _____ IS ATTACHED	PHONE: (WORK) (     ) _____ PHONE: (HOME) (     ) _____ STATION:            (     ) _____ FAX                    (     ) _____
PAYMENT IS REQUIRED WITH SUBMISSION OF THIS REGISTRATION FORM. REFUNDS WILL BE MADE ACCORDING TO POLICIES OUTLINED IN COURSE PUBLICATION.	

**PLEASE PRINT ALL INFORMATION CAREFULLY**

<b>PRE-REGISTRATION FOR:</b>	<b>DATES OF COURSE:</b>
<b>PREREQUISITES:</b>	<b>ATTACH COPIES OF CERTIFICATES</b>
<b>COURSE #:</b>	<b>RETURN BY: 10 DAYS PRIOR TO START OF CLASS</b>

1.	LAST NAME	FIRST NAME	MI	SOCIAL SECURITY	PHONE NUMBER
2.					
3.					
4.					
5.					
6.					

**Dress:** CLASSROOM: CASUAL

**CUTOFFS or SHORTS NOT PERMITTED**

DRILL FIELD: FULL PPE & SCBA WHEN NECESSARY

WE CERTIFY THAT THE STUDENTS LISTED ABOVE DO NOT HAVE ANY PHYSICAL AND/OR OTHER CONDITIONS THAT WOULD PREVENT THEM ACTIVELY PARTICIPATING IN ALL PORTIONS OF THIS COURSE. WE UNDERSTAND THAT PAYMENT FOR ANY MEDICAL, FIRST AID, DAMAGED EQUIPMENT, AND RELATED CHARGES WILL BE THE RESPONSIBILITY OF THE SPONSORING ORGANIZATION. SUBMISSION OF A SIGNED APPLICATION AUTOMATICALLY INDICATES COMPANY/DEPARTMENT AGREES TO POLICIES OUTLINED IN COURSE PUBLICATION.

<b>FIRE DEPT/CO OR OTHER SPONSORING ORGANIZATION: PRINT CLEARLY</b>	
NAME: _____	
ADDRESS: _____ (Please include on all registration forms, No Exceptions)	
THE ABOVE CONDITIONS ARE UNDERSTOOD AND STUDENTS ATTENDING ARE AUTHORIZED BY:	PRINT SIGNATURE:
AUTHORIZED SIGNATURE                      DATE:	TITLE:
FORM OF PAYMENT: CO. CHECK _____ CO. VOUCHER/PO _____ PERSONAL CHECK _____ IN THE AMOUNT OF \$ _____ IS ATTACHED	PHONE: (WORK) (     ) _____ PHONE: (HOME) (     ) _____ STATION:            (     ) _____ FAX                    (     ) _____
PAYMENT IS REQUIRED WITH SUBMISSION OF THIS REGISTRATION FORM. REFUNDS WILL BE MADE ACCORDING TO POLICIES OUTLINED IN COURSE PUBLICATION.	

**PLEASE PRINT ALL INFORMATION CAREFULLY**

PRE-REGISTRATION FOR:	DATES OF COURSE:
PREREQUISITES	ATTACH COPIES OF CERTIFICATES
COURSE #:	<b>RETURN BY: 10 DAYS PRIOR TO START OF CLASS</b>

LAST NAME	FIRST NAME	MI	SOCIAL SECURITY	PHONE NUMBER
1.				
2.				
3.				
4.				
5.				
6.				

**Dress: CLASSROOM: CASUAL**

**CUTOFFS or SHORTS NOT PERMITTED**

**DRILL FIELD: FULL PPE & SCBA WHEN NECESSARY**

WE CERTIFY THAT THE STUDENTS LISTED ABOVE DO NOT HAVE ANY PHYSICAL AND/OR OTHER CONDITIONS THAT WOULD PREVENT THEM ACTIVELY PARTICIPATING IN ALL PORTIONS OF THIS COURSE. WE UNDERSTAND THAT PAYMENT FOR ANY MEDICAL, FIRST AID, DAMAGED EQUIPMENT, AND RELATED CHARGES WILL BE THE RESPONSIBILITY OF THE SPONSORING ORGANIZATION. SUBMISSION OF A SIGNED APPLICATION AUTOMATICALLY INDICATES COMPANY/DEPARTMENT AGREES TO POLICIES OUTLINED IN COURSE PUBLICATION.

<b>FIRE DEPT/CO OR OTHER SPONSORING ORGANIZATION: PRINT CLEARLY</b> <b>NAME:</b> _____ <b>ADDRESS:</b> _____ <b>(Please include on all registration forms, No Exceptions)</b>	
<b>THE ABOVE CONDITIONS ARE UNDERSTOOD AND STUDENTS ATTENDING ARE AUTHORIZED BY:</b>	<b>PRINT SIGNATURE:</b>
<b>AUTHORIZED SIGNATURE</b> _____ <b>DATE:</b> _____	<b>TITLE:</b>
<b>FORM OF PAYMENT: CO. CHECK</b> _____ <b>CO. VOUCHER/PO</b> _____ <b>PERSONAL CHECK</b> _____ <b>IN THE AMOUNT OF \$</b> _____ <b>IS</b> <b>ATTACHED</b>	<b>PHONE: (WORK) (        )</b> _____ <b>PHONE: (HOME) (        )</b> _____ <b>STATION: (        )</b> _____ <b>FAX (        )</b> _____
<b>PAYMENT IS REQUIRED WITH SUBMISSION OF THIS REGISTRATION FORM. REFUNDS WILL BE MADE ACCORDING TO POLICIES OUTLINED IN COURSE PUBLICATION.</b>	

**PLEASE PRINT ALL INFORMATION CAREFULLY**

<b>PRE-REGISTRATION FOR:</b>	<b>DATES OF COURSE:</b>
<b>PREREQUISITES:</b>	<b>ATTACH COPIES OF CERTIFICATES</b>
<b>COURSE #:</b>	<b>RETURN BY: 10 DAYS PRIOR TO START OF CLASS</b>

LAST NAME	FIRST NAME	MI	SOCIAL SECURITY	PHONE NUMBER
1.				
2.				
3.				
4.				
5.				
6.				

**Dress: CLASSROOM: CASUAL**

**CUTOFFS or SHORTS NOT PERMITTED**

**DRILL FIELD: FULL PPE & SCBA WHEN NECESSARY**

WE CERTIFY THAT THE STUDENTS LISTED ABOVE DO NOT HAVE ANY PHYSICAL AND/OR OTHER CONDITIONS THAT WOULD PREVENT THEM ACTIVELY PARTICIPATING IN ALL PORTIONS OF THIS COURSE. WE UNDERSTAND THAT PAYMENT FOR ANY MEDICAL, FIRST AID, DAMAGED EQUIPMENT, AND RELATED CHARGES WILL BE THE RESPONSIBILITY OF THE SPONSORING ORGANIZATION. SUBMISSION OF A SIGNED APPLICATION AUTOMATICALLY INDICATES COMPANY/DEPARTMENT AGREES TO POLICIES OUTLINED IN COURSE PUBLICATION.

<b>FIRE DEPT/CO OR OTHER SPONSORING ORGANIZATION: PRINT CLEARLY</b> <b>NAME:</b> _____ <b>ADDRESS:</b> _____ <b>(Please include on all registration forms, No Exceptions)</b>	
<b>THE ABOVE CONDITIONS ARE UNDERSTOOD AND STUDENTS ATTENDING ARE AUTHORIZED BY:</b>	<b>PRINT SIGNATURE:</b>
<b>AUTHORIZED SIGNATURE</b>	<b>DATE:</b>
<b>FORM OF PAYMENT: CO. CHECK _____</b> <b>CO. VOUCHER/PO _____ PERSONAL CHECK _____</b> <b>IN THE AMOUNT OF \$ _____ IS</b> <b>ATTACHED</b>	<b>PHONE: (WORK) (     ) _____</b> <b>PHONE: (HOME) (     ) _____</b> <b>STATION: (     ) _____</b> <b>FAX (     ) _____</b>
<b>PAYMENT IS REQUIRED WITH SUBMISSION OF THIS REGISTRATION FORM. REFUNDS WILL BE MADE ACCORDING TO POLICIES OUTLINED IN COURSE PUBLICATION.</b>	