

Atlantic County Fire Academy/Fire Training Center

TRAINING COURSE ANNOUNCEMENT



Fall 2023

“PRESIDENT”

Charles Mackintosh

1st VICE PRESIDENT

Dennis Sharpe

2nd VICE PRESIDENT

William Merola, Jr.

SECRETARY

Robert A. Mellon

TREASURER

Jaime C. Mellon

ASSISTANT SECRETARY/TREASURER

Sandy Walczak

“EXECUTIVE COMMITTEE”

CHAIRMAN

Howard Berchtold, Jr.

Levon “Lefty” Clayton, Vice Chairman

Marc J. Corsiglia

Kimball Feinstein

Joseph Hartman

Walter "Butch" Kienzle, III

Christopher Kislow

Eugene M. Sharpe

Charles “Rob” Winkler III

“ATLANTIC COUNTY DIRECTOR OF FIRE TRAINING”

Brian Middleton

“FIRE TRAINING CENTER INSTRUCTORS”

Dan Adams

David Buzby

Michael Cahill

Levon “Lefty” Clayton

Michael Corbo

Lauren Crooks

Thomas J. Culleney

Eric Grace

Marylynn Graham

William Hancock

Sherman Hartman

William Higbee

Casey Hunt

Chris Kislow

Sean Macri

William Merola

Eric Moran

Louis Raciti

Joseph Rush

Kolby Rundio

Dennis Sharpe

Joseph Ward

Timothy Welsh

William Wilkinson

Charles “Rob” Winkler III

Brandon Zonge

Gilbert Zonge, Jr.

Atlantic County Fire Academy
Spring 2023 Class Schedule
Table of Contents

	Page #
ACFFA Officers & Executive Board	i
ACFA Instructors	i
Calendar	iv
Purpose	1
Prerequisites	1
Application Procedures	1
Confirmation	2
Cancellation Policy	2
Refund Policy	2
Substitutions	2
Walk-in Registration	2
Physical Conditions of Students	3
First Session Registration and Attendance	3
Make-up Policy	3
Dress Codes	
Beards & Self-contained Breathing Apparatus	4
Personal Protective Equipment	4
SCBA Use	4
Certificate of Insurance	5
Financial Responsibility for Medical Treatment	5
Use of Atlantic County Fire Academy for Live Burns	5
Other Seminar Offerings	5
Firefighter I: Rules & Regulations	6
Firefighter I Agility Test	8
Firefighter I: Present Semester Schedule	10
Firefighter II: Present Semester Schedule	11

Course Offerings:

Atlantic County Fire Academy Programs:

Firefighter I	13
Firefighter II	13
Advanced Vehicle Extrication	14
Sizing Up the Incident	14
Heavy Vehicle Rescue	15
Wednesday Night Live Burns	16
Flashover Awareness & Simulator	17
Engine Company Operations	18
Thermal Imaging	19
Incident safety Officer	20
ICS-200	21
Fire Officer 1	21
Building Construction	22

Atlantic County Fire Academy
Spring 2023 Class Schedule
Table of Contents

Firefighter I Registration Form	24
Firefighter I Medical Form	25 - 26
SCBA Fit Test Certification	27
Registration Forms	28 - 32

GENERAL INFORMATION

PURPOSE

The purpose of this course announcement is to provide interested students of firefighting with important information about course offerings and the forms necessary for making application. All training will be conducted by, and at the facilities of, the Atlantic County Fire Training Center. Specific information on the content of each course offering is found in the pages that follow.

PREREQUISITES

Firefighting courses are structured sequentially. For this reason, prerequisites have been established for many courses so that each student will have the necessary background to gain the most from each student area. Since many courses build upon the knowledge gained in the prerequisite courses, an unprepared student will not only fail to understand some of the material, they will also slow the progress of the entire class. Please note that prerequisites are indicated in the course description section for each Academy course. Make sure your personnel are qualified for that class.

If a person has taken a course that is a prerequisite for an Academy course from an institution other than the Atlantic County Fire Academy (ACFA), he or she must supply documentation of this at the time of application. Copies of certificates for these courses must accompany the course application in order to receive equivalency credit for that course.

APPLICATION PROCEDURE

Personnel desiring to enroll into any course must do so through their respective Chief or Training Officer. All applications must be submitted at least 10 days prior to the commencement of the Class. **All information requested on the application must be provided for enrollment. The application will be returned if areas are left blank.** No walk-in will be accepted for any class that is not designated open enrollment. **A check or voucher must accompany each registration form.** Blank registration forms are in the back of this training announcement.

A separate registration form for Firefighter 1 is required along with a completed Medical Form. Both forms can be found in the back of this announcement.

CONFIRMATION

No course confirmation will be sent to enrolled students. If the course is canceled or rescheduled for any reason, the contact person listed on the registration form will be contacted. It is the responsibility of the student and sending department to see that either the student or a replacement shows up for the scheduled class. No refunds will be given for registered students who fail to show up.

CANCELLATION POLICY

If you have to cancel a person for some reason, you may cancel up to 14 days before the class. If you do not notify the Academy by that time, and the person or qualified replacement does not show up on the first day of the class, the tuition will **not** be refunded.

REFUND POLICY

A refund of the course fee will be made for a student cancellation up to 14 days prior to the start of the course. Refunds cannot be made once the class starts including dropouts. If a course is canceled by the Academy for lack of student enrollment, all fees will be refunded.

SUBSTITUTIONS

Should an accepted student discover that he/she would be unable to attend a course, a substitution may be possible. For a substitution request to be granted, the substitute must meet all of the prerequisites for the course. The substitute must attend the 1st class and notify the instructor of the substitution. **Failure to provide a substitute will forfeit tuition paid unless the Academy is notified within 14 days prior to the start of the course.**

WALK IN REGISTRATION

Students wishing to register the first day of class may do so provided the class is not full. If you walk in and the class has already met its enrollment capacity, you will not be accepted. Walk-in registration will be on a first in basis with payment due prior to start of the class.

Unless otherwise noted, only open classes that do not have a maximum enrollment will be allowed to increase.

PHYSICAL CONDITION OF STUDENTS

No student shall be admitted to class with any physical and/or other condition that would prevent them from safely participating in class activities. No student shall be given credit for any unit of instruction in which he or she did not or could not actively participate. Students who do not actively participate in any portion of the class will not be given a certificate of completion for the class and will not be eligible to return for other courses for which the completed course is a prerequisite.

All students participating in a class requiring the use of a SCBA will be required to sign a SCBA Mask Fit Certification Form found in the back of the booklet certifying that they are physical fit to take the class and have received a mask fit test in the last 12 months.

FIRST SESSION REGISTRATION AND ATTENDANCE

Registration will be conducted at the first-class meeting of each course. For several courses, attendance at the first class is mandatory, for other classes, the first class may be missed, but only with advance permission from the Academy. Students who are not in attendance for mandatory first-class meeting or without prior approval to miss the first class will be dropped from the course. There will be no refunds for those who fail to attend the first session. Substitutions are allowed; refer to the section on "Substitutions".

Students are responsible to sign the roster for each lesson to receive credit for that lesson. Make-up students are responsible for signing the roster with their original class number, in order to receive credit. Please inform the instructor that you are making up a class from a previous course.

Students shall not leave the Academy prior to class dismissal without permission from the instructor in charge of the class.

MAKE-UP POLICY

Any students who have missed lessons/modules in Academy courses have two (2) year from the date the lesson was missed to make up the lesson. This is especially important for Firefighter I and Firefighter II in which attendance of all modules is mandated by the State of NJ.

The procedure for make-ups will be as follows:

1. The student shall check the student handout to make sure of the date of the make-up class. For students making up Firefighter I or II classes, a copy of the semester schedule is provided in this announcement. Students should call 609-407-6743 to verify that the class has not been changed.

2. When signing the roster, each student shall print clearly his or her:

- a. Full legal name
- b. Fire Department/Company represented
- c. Course number of the original class
- d. Signature

DRESS CODES

BEARDS & SELF-CONTAINED BREATHING APPARATUS

In accordance with N.F.P.A. 1500: 5-3.10, “Standard on Fire Department Occupational Safety and Health Program”, and OSHA 29 CFR 1910.134, the Atlantic County Fire Training Center policy prohibits training individuals with facial hair that interferes with the mask seal on positive pressure self-contained breathing apparatus in those courses where SCBA must be worn. Those students with beards, or such facial hair **that does** interfere with the face-to-mask seal may **not** participate in some blocks of instruction and, therefore, cannot be given credit toward completion of those courses

PERSONAL PROTECTIVE EQUIPMENT

Many of the courses offered at the ACFTC require each student to actively participate in actual firefighting evolutions, (live fire burns, and other practical evolutions). Each student involved in these training areas must provide and wear their own personal protective equipment (PPE). The academy cannot loan firefighters PPE to those improperly prepared. PPE shall include the complete and proper wearing of approved boots, turnout coat and pants, leather gloves, helmet, and eye protection, and Nomex or PBI hood. All this equipment must meet the NJ PEOSHA PPE requirements for firefighters.

The ACFTC will not be responsible for PPE or other department/company equipment damaged during training activities. Any reimbursement or replacement for damaged equipment should be submitted to the department/company's insurance company.

The wearing of jewelry by students to class is discouraged. Jewelry that can be removed **must** be removed and secured by the student prior to participating in outdoor activities. The ACFTC will not be responsible for lost jewelry.

SCBA USE

In all courses/classes requiring the use of SCBA, it shall be the student's responsibility to bring a full spare cylinder with each SCBA. Please make sure that the SCBA and Cylinders are **MARKED** with your Department/Company identification prior to use at the ACFTC. All SCBA used must be properly.

hydrostatically tested. Any unit failing inspection will not be permitted to be used and the student will not be permitted to participate and will not be given credit for the class.

All students participating in training that puts them in an IDLH atmosphere must provide a signed **SCBA Mask Fit Certification Form** by their fire chief and bring it to the start of the course they are participating in. The Student Certification part of the form will be filled out prior to the start of the class in front of the lead instructor. A copy of the form is available in the back of this course announcement.

CERTIFICATE OF INSURANCE

Each participating Department/Company must have current proof of liability and workmen's compensation insurance and indemnification on file at the ACFTC. Certificates can be sent to Director of Training, ACFTC, 5033 English Creek Avenue, Egg Harbor Township, NJ 08234-5743.

FINANCIAL RESPONSIBILITY FOR MEDICAL TREATMENT

Any payment for any and all medical related charges will be the responsibility of the sponsoring organization or the student's fire department.

USE OF ATLANTIC COUNTY FIRE ACADEMY FOR LIVE BURN OPERATIONS

Any fire company/department inside or outside Atlantic County may use the fire academy for live burn operations. The procedures are as follows:

1. Obtain any facility application from either the Atlantic County Firefighters' Association website, atlanticcountyfireassoc.org, or call 609-407-6752
2. Fill out the application picking two dates and times that you want to burn.
3. Submit the application to the fire academy by either fax at 609-407-6745 or mail to the address listed on the application.
4. The dates you requested will be checked for availability and you will be contacted if they are available.
5. **Due to the changes in NFPA 1403, Live Burn Standard, you will have to pay for 4 academy instructors to run your burn.**

6. You must also provide a dedicated EMT with a trauma bag, & defibrillator. If you do not have one, the academy will provide one at the instructor's cost.
7. The fee for using the burn building will be as follows:
 - a. In county: \$25.00 per hour per instructor, plus straw @ \$7.25 per bale.
 - b. Out - of - county: \$30.00 per hour, per instructor, plus straw @ \$7.25 per bale.

OTHER SEMINAR OFFERINGS

From time-to-time other seminars will be offered that are not listed in this bulletin. You will be notified by the Academy as to the dates and times as they become available.

FIREFIGHTER I: RULES AND REGULATIONS

1. All evening classes start promptly on time at 7:00 p.m. All Saturday & Sunday classes start promptly at 8:30 a.m., unless otherwise specified.
2. Students will not leave class or drills prior to being dismissed.
3. All turn-out gear must fit properly, be free of rips and tears, and be PEOSHA approved as per P.L. 1983. Your gear will be inspected by your instructors for compliance.
4. Beards or excessive facial hair are not permitted. Anyone having such will not be permitted to attend firefighter I.
5. All classes are mandatory. You must attend. **NO EXCEPTIONS. In order to graduate Firefighter, I, you must make all classes and drills. If you miss any, you will have two years to make them up to receive a certificate of completion issued by the Fire Academy.** Failure to make it all in two years will result in restarting firefighter I from the beginning at the cost of \$350.00.
6. **Any student missing more than 10 classes must repeat the entire course and pay tuition of \$350.00.**
7. Any student missing SCBA Drill II & HNA Drill II will not be allowed to participate in any live fire evolutions.
8. **All radio pagers and cell phones shall be in the "off" position during class. Violations will result with phones being left on the front table.**
9. There is to be no food or drinks outside the cafeteria in classrooms or hallways. Water is an exception and may be taken into the classroom.

10. Students are responsible for maintaining any books, equipment, apparatus, or buildings made available for their use.
11. All students must be prepared for class and have any homework assignments completed. This also means bringing a pencil/pen and something to write on.
12. Students are required to police the classroom and training grounds at the end of each training session. This includes the area around your seat and to push your seat in under the table when you leave. These facilities must be left the way we found them.
13. Students must receive a 70% passing grade on final examination. Any student who fails the State exam will have two opportunities to take a make-up. The scheduling for such exam will be at the discretion of the Director of the ACFA.
14. Any student who has a learning disability is to notify the lead instructor or the Training Director.
15. There is to be absolutely no horseplay or disturbances in class or on the training grounds as this could lead to unsafe conditions and injury or possible dismissal from course.
16. Injuries of any nature incurred during training, either during class or on the drill-field, must be reported immediately to the Lead Instructor in charge or his staff. Accordingly, the respective Fire Chief will be notified.
17. Students will come dressed properly for class and training. No shorts, jeans, flip flops or open toe sandals. All students are required to wear their golf shirts during classroom presentations and their tee shirts during all outside training. Also, all students are to wear a dark blue or black pair of uniform pants with black boots. Students will be given one exception if not dressed properly, after that they will be asked to leave class. After a third violation they will be dismissed from class permanently. During drills, students are to come dressed properly but may wear their T-shirt. A fire company sweatshirt may be worn over T-shirts during cold weather.
18. No tobacco products will be permitted in any buildings and may be used only in areas designated by the instructors on the drill field.
19. Students must have a copy of their Municipalities Insurance Coverage on file with the Atlantic County Fire Academy.
20. The County of Atlantic has a "Zero Tolerance" policy on sexual harassment. Any student found breaking the policy will be dismissed from class permanently.

21. If anyone is suspected of being under the influence of alcohol or drugs, they will be removed from the classroom or training evolution. The ACFA has a “Zero Tolerance” policy. You will be given one violation. Two violations of this rule will result in dismissal from class.
22. No sleeping will be permitted during class. If you sleep, you will be required to make-up the class.
23. All students are to be familiar with the training cites, emergency exits, and the emergency evacuation signal during any hands-on training.
24. Please leave your attitudes and opinions at the door when you come in. You are here to learn how to be a firefighter. We know what we are doing, so just sit, be quiet, ask questions, and learn.

FIREFIGHTER I AGILITY TEST

All firefighters who want to attend Firefighter 1 at the Atlantic County Fire Academy must pass an entrance test consisting of an agility test, ladder climb, and maze crawl. Below are two drawings of the agility test and maze crawl. Students will be notified on the first night of class when the agility test will be held. If you fail the agility test, you will be removed from class.

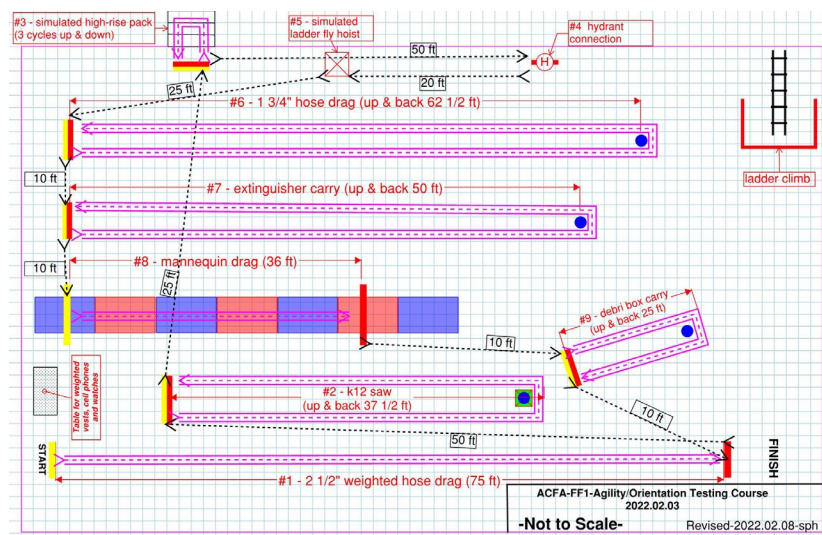

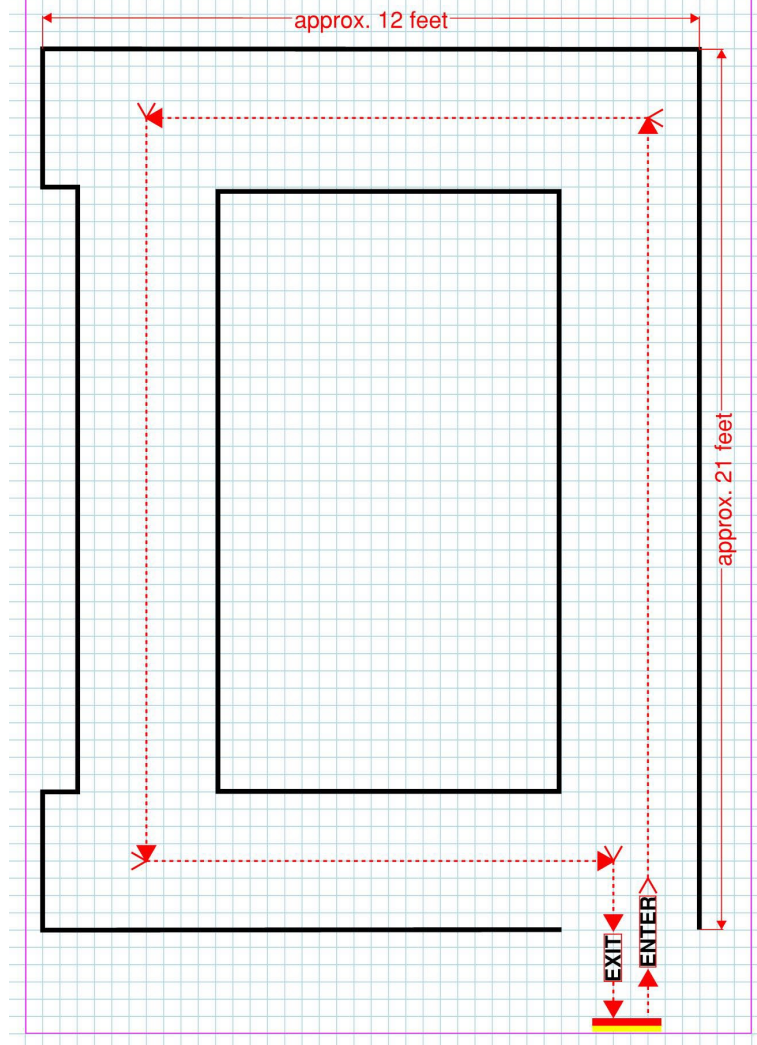

FALL 2023 - Firefighter I Schedule

Date	Class	Time	Lead Inst.	Notes
August				
Thur. 08/17	Registration	7:00 - 10:00	Middleton	
Sun. 08/20	Agility Test & Fit Test	8:30 - 12:30	Staff	
Tues. 08/22	Orientation	7:00 - 10:00	Kislow	
Thurs. 08/24	Fire Behavior	7:00 - 10:00	Corbo	
Sun. 08/27	Haz-Mat Awareness	8:30 - 4:30	Corbo	
Tues. 08/29	Ropes And Knots	7:00 - 10:00	Zonge	Bring 10' piece of 3/8" or 1/2" braided nylon rope
Thurs. 08/31	Firefighter Safety	7:00 - 10:00	Graham	Bring Full Gear
September				
Tues. 09/05	SCBA Lecture	7:00 - 10:00+	Cahill	
Thurs. 09/07	SCBA Drill 1	7:00 - 10:00	Cahill	Bring Full Gear & SCBA
Sun. 09/10	HazMat OPS	8:30 - 4:30	Corbo	
Tues. 09/12	HNA, Fire Streams & Water Supply	7:00 - 10:00	Kislow	
Thurs. 09/14	Fire Control	7:00 - 10:00	Staff	
Tues. 09/19	Ladder Lect,	7:00 - 10:00	Cahill	
Thur. 09/21	Ladder Drill 1	7:00 - 10:00	Staff	Bring Full Gear, SCBA & Your Rope
Sun. 09/24	HNA Drill I	8:30 - 4:30	Kislow	Bring Full Gear, SCBA & Your Rope
Tues. 09/26	FE Lecture	7:00 - 10:00	Merola	
Thur. 09/28	FE Drill	7:00 - 10:00	Merola	Bring Full Gear, SCBA & Your Rope
October				
Sun. 10/1	TIMS	8:30 - 4:30	Zonge	
Tues. 10/3	Rescue Lecture	7:00 - 10:00	Moran	
Thur. 10/5	Rescue Drill	7:00 - 10:00	Moran	Bring Full Gear, SCBA & Your Rope
Sun. 10/8	HazMat Practical&Exam	8:30 - 4:30	Staff	Bring Full Gear, SCBA & Your Rope
Tues. 10/10	Building Construction	7:00 - 10:00	Cahill	
Thurs. 10/12	Fire Extinguishers	7:00 - 10:00	Kislow	Bring Full Gear, Your Rope,
Sun. 10/15	Ladder Drill 2	8:30 - 4:30	Staff	Bring Full Gear, SCBA & Your Rope
Tues. 10/17	Autism & RIT Awareness	7:00 - 10:00+	Winkler	

Thurs. 10/19	Resiliency	7:00 – 10:00	Cahill	
Sun. 10/22	HNA Drill 2	8:30 – 4:30	Kislow	Bring Full Gear, Your Rope, SCBA & Spare Bottle
Tues. 10/24	Vent Lecture	7:00 - 10:00	Grace	
Thurs. 10/26	Vent Drill	7:00 – 10:00	Grace	Bring Full Gear, Your Rope, SCBA
Sun. 10/29	SCBA Drill 2	8:30 – 4:30	Zonge	Bring Full Gear, Your Rope, SCBA & Spare Bottle
Tues. 10/31	Sprinklers & Fire Alarms	7:00 – 10:00	Kislow	Bring Full Gear
November				
Thurs. 11/2	Thermal Balance & Car Fires	7:00 - 10:00	Zonge	Bring Full Gear, Your Rope, SCBA & Spare Bottle
Sun. 11/5	Live Burn	8:30 – 4:30	Staff	Bring Full Gear, Your Rope, SCBA & Spare Bottle
Tues. 11/7	Salvage	7:00 – 10:00	Higbee	
Thurs. 11/9	Utility Emergencies	7:00 - 10:00	Merola	
Tues. 11/14	BBP	7:00 - 10:00	Corbo	
Thurs. 11/16	Night Burn 1	7:00 - 10:00	Staff	Bring Full Gear, Your Rope, SCBA & Spare Bottle
Sun. 11/19	CPR	8:30 – 4:30	Zonge	
Tues. 11/21	Night Burn 2	7:00 – 10:00	Staff	Bring Full Gear, Your Rope, SCBA & Spare Bottle
Tues. 11/28	Wildland Firefighting	7:00 - 10:00	NJFFS	
Thurs. 11/30	Burns & HCN	7:00 - 10:00	Kislow	
December				
Tues. 12/5.	WMD - Awareness	7:00 - 10:00	Corbo	
Thurs. 12/7	Practical Prep	7:00 – 10:00	Zonge	
Sun. 12/10	Practical Exam	8:30 – 4:30	Staff	
Tues. 12/12	Written Test Review	7:00 - 10:00	Corbo	
Thurs. 12/14	Open Night	7:00 – 10:00	Staff	
Tues. 12/19	Written Exam	7:00 - 10:00	Middleton	

FALL 2023 - NJ Firefighter II Program Schedule

September				
Mon. 09/11	Registration, Report Writing & Communications	7:00 - 10:00	Corbo	
Wed. 09/13	Tech Rescue Support Ops	7:00 – 10:00	Zonge	

Mon. 09/18	Tech Rescue Support Ops	7:00 - 10:00	Winkler	
Wed. 09/20	Building Construction	7:00 - 10:00	Cahill	
Sat. 09/23	CEVO III	8:30 - 4:30	Corbo	
Mon. 09/25	Foam Ops	7:00 - 10:00	Corbo	
Wed. 09/27	Firefighter Survival	7:00 - 10:00	Zonge	Bring Full Gear, SCBA
Sat. 09/30	Foam Ops, Equip & Hose Test	8:30 - 4:30	Ward	Bring Full Gear, SCBA
October				
Mon. 10/2	Firefighter Survival	7:00 - 10:00	Zonge	Bring Full Gear
Wed. 10/4	Firefighter Survival	7:00 - 10:00	Zonge	Bring Full Gear, SCBA
Wed. 10/11	HNA/Pump	7:00 - 10:00	Corbo	
Sat. 10/14	Rope Rescue	8:30 - 4:30	Zonge	Hard Hat, Gloves & Work Boots
Mon. 10/16	Propane & Flashover Lect	7:00 - 10:00	Zonge	
Wed. 10/18	Flashover	7:00 - 10:00	Zonge	Bring Full Gear, SCBA
Sat. 10/21	Vehicle Extrication	8:30 - 4:30	Zonge	Bring Full Gear
Mon. 10/23	Propane Practical	7:00 - 10:00	Zonge	Bring Full Gear, SCBA & Spare Bottle
Wed. 10/25	ICS-200	7:00 - 10:00	Corbo	
Sat. 10/28	ICS-200	8:30 - 4:30	Corbo	
Mon. 10/30	Advance Vent.	7:00 - 10:00	Grace	
November				
Wed 11/1	Basic First Aid.	7:00 - 10:00	Crooks	
Sat. 11/4	Fire Suppression	8:30 - 4:30	Staff	Bring Full Gear, SCBA & Spare Bottle
Mon. 11/6	Fire Determination	7:00 - 10:00	Staff	
Wed. 11/8	Fire Suppression	7:00 - 10:00	Staff	Bring Full Gear, SCBA & Spare Bottle
Mon. 11/13	Open Night	7:00 - 10:00	Staff	
Wed. 11/15	HazMat Spill Response	8:30 - 4:30	Staff	Bring Full Gear
Mon. 11/20	Test Review	7:00 - 10:00	Corbo	
Mon. 11/27	Written & Practical Test	7:00 - 10:00	Staff	

FIREFIGHTER I (Tuesday & Thursday & 8 Sundays)

See Page 10 for Schedule

Course #: FFI - F23

This Firefighter I program will provide the training necessary to attain the minimum basic skills the firefighter must have to safely perform duties at the entry level. This program meets the requirements of the New Jersey Division of Fire Safety for Firefighter Level I under N.J.A.C. 5:18C and follows the N.F.P.A. 1001. NJ State Police Hazardous Materials Awareness and Operations, NJ Department of Health Blood Borne Pathogens, NJ Forest Fire Service's Basic Ground Cover Fires, Critical Incident Stress, CBRNE Awareness & Operations, Incident Command System I-100 & 700, Autism & RIT Awareness, SCBA Mask Fit test, & CPR for the Professional Rescuer classes are included in this program.

PREREQUISITE: At least 18 years of age and an active member of an organized fire department.

Class Limit: (40 Students)
Location: Fire Training Center
Classroom: #2 & Drill Field

Class Hours: 180
Fee: In County: Free*
Out of County: \$350.00*

Date: AUGUST 17 thru DECEMBER 19, 2023

Tuesdays & Thursdays: (7:00 - 10:00 PM.)

Sundays: (8:30 - 4:30 PM)

Instructors: Staff

***(Out of county tuition includes Class Golf & T- shirts, In-county must pay \$30.00,
All students must pay \$40.00 for CPR if not already certified)**

FULL PPE REQUIRED FOR OUTSIDE EVOLUTIONS

**

FIREFIGHTER II (Monday & Wednesday & 7 Saturdays)

See Page 11 for Schedule

Course #: FFII -

S23

This firefighter II program is based on the new curriculum adopted by the NJ Division of Fire Safety. It will provide the Firefighter I student with the necessary training to increase his firefighter skills. A large majority of the course is devoted to practical exercises in the areas of firefighter survival, rope rescue, advanced search & rescue, propane firefighting, vehicle extrication, basic first aid, technical rescue support, and other fire ground activities.

PREREQUISITE: Firefighter Level I.

Class Limit: 30 Students
Location: Fire Training Center
Classroom: #2 & Drill Field

Class Hours: 110
Fee: \$375.00

Date: SEPTEMBER 11 thru NOVEMBER 27, 2023

Mondays and Wednesdays: (7:00 - 10:00 PM)

Saturdays: (8:30 AM - 4:30 PM)

Instructors: Staff

FULL PPE REQUIRED FOR OUTSIDE EVOLUTIONS

YOU MUST BRING A COMPLETED SCBA FACE FIT CERTIFICATION FORM. (SEE END OF THIS BOOK FOR FORM)

Atlantic County Fire Academy
5033 English Creek Avenue
Egg Harbor Township, NJ 08234

ADVANCED VEHICLE EXTRICATION *Course #: AVE - F23*

This course has been updated with more information and some night operations. It continues the Firefighter's training on vehicle extrication by allowing the Firefighter to apply what was learned in Basic Vehicle Extrication, while also providing information on dealing with advanced extrication situations. The course combines both classroom and outside evolutions, which will consist of several scenarios that the Firefighter will size up and then utilize proper procedures & equipment. All scenarios will be critiqued by the instructors with beneficial feedback provided.

PREREQUISITE: Basic Vehicle Extrication

Class Limit: 20

Class Minimum: 15

Location: Fire Training Center

Classroom: #2 & Drill Field

Date: September 29 & 30, 2023

Gil Zonge, Fire Chief

Friday: (7:00 - 10:00 PM)

Technical

Saturday: (8:30 AM - 4:30 PM)

Class Hours: 11

1st Class Mandatory

Fee: \$100.00 (includes lunch
on Saturday)

Lead Instructor:

Cardiff Fire Company, EHT

Rescue Team Leader

FULL PPE REQUIRED FOR OUTSIDE EVOLUTIONS

SIZING UP THE INCIDENT

Course #: Sz/Sm -

S19

"A picture is worth a thousand words." The initial report and scene size up should paint this picture for all responding units without using a thousand words. Every emergency scene requires a size up, the fire ground, EMS scene and the hazardous materials incident.

Saturday: The class will cover the various components of the scene size up and to what level each factor can or will impact an incident, giving the students the tools to paint an accurate and compressive picture. There are 3 areas that need to be covered by the initial unit to arrive at the scene to obtain this graphic picture.

1. What have I got?
2. Where is it going and what can I do about it?
3. What do I need?

Both segments of the class will highlight the evolving scene dynamics of the fire ground and the need for the continual size up process.

PREREQUISITE: Firefighter Level I & the desire to operate on a safe fire ground through critical observations.

Class limit: 30

Class minimum: 8

Location: Fire Training Center

Date: November 11, 2023

Saturday 830-1630

Class Hours: 8

Fee: 45.00

Lead Instructors: Michael Cahill, Fire Chief
Ventnor City Fire Department

Heavy Vehicle Rescue

Course # HVR-F23

The Heavy Vehicle Rescue course is a specialized program focusing on accidents involving large trucks and automobiles. The student will face different scenarios where large trucks will need to be stabilized and lifted so that extrication can be completed safely. Students will work with air bags and cribbing for lifting and rescue struts for stabilization.

PREREQUISITE: Firefighter Level I

Class limit: 40

Class minimum: 34

Location: Egg Harbor Township Public Works

Date: November 10 , 11 & 12 2023

Friday: (7:00 - 10:00 PM)

Saturday & Sunday: (8:30 AM - 4:30 PM)

Class Hours: 19

Fee: \$175.00 (Includes lunch on Saturday & Sunday)

Lead Instructors: Atlantic County &
Gloucester County Fire Academy Staff

Full PPE required on Saturday & Sunday. In addition, safety glasses or goggles, NFPA cut resistant gloves, handlight, small calculator, & pen/pencil.

Friday night's class will be at the Atlantic County Fire Academy



WEDNESDAY NIGHT LIVE BURN FIREFIGHTING

*Course #: WLB * F-23*

**(insert # of date in space, e.g. WLB-3-1-23)*

To meet the growing demand for live fire training, the Atlantic County Fire Academy will offer live fire training on the first Wednesday night of each month starting in April thru June during the Spring Semester and September thru November in the Fall Semester, weather permitting. The type of burn evolutions (basement, attic, multi room, etc.) will be determined by the instructors and students attending the training.

The class will be limited to 12 firefighters each night. Anyone wishing to participate will need to **pre-register**.

PREREQUISITE: NJDFS Firefighter I Certification.

Class Limit: 12 Students

Class Hours: 3

Class Minimum: 6 Students

Location: Fire Training Center Burn Bldg

Fee: \$50.00

Wednesday: (7:00 - 10:00 PM)

Instructors: Staff

Dates:
August 2, 2023
September 6, 2023
October 4, 2023
November 1, 2023



All participants should arrive by at least 6:45 p.m. You must now pre-register for this class. If there are not enough students signed up, the **class will be cancelled**. All registered students will be notified prior to Wednesday night if class is cancelled.

FULL PPE, SCBA AND SPARE CYLINDER REQUIRED FOR ALL EVOLUTIONS

YOU MUST BRING A COMPLETED SCBA FACE FIT CERTIFICATION FORM. (SEE END OF THIS BOOK FOR FORM)

**

FLASHOVER AWARENESS & SIMULATOR

*Course #: FOS * F-23*

**(insert Date in space, e.g., FOS: 3-6-23)*

The Atlantic County Fire Academy is excited to be able to deliver one of the premier training experiences that provides firefighters with the best live fire training program currently available to the fire service.

The Simulator known as the "Can" is a laboratory, designed to provide firefighters with a safe and secure system to recognize the signs of a flashover. The burning of Class "A" combustibles will take place in the burn chamber, located three feet off the ground. Firefighters will be able to witness a fire grow from an incipient stage to flashover conditions. As the combustibles burn, the interior instructors will have the ability to control the conditions inside the simulator through the combined use of ventilation and "penciling of water." It is through this management that firefighters are able to experience a safe observation of a flashover. Students will attend classroom instruction prior to entering the simulator.

Key points of the system include incipient phase of the fire, fire growth, smoke production, high- and low-pressure zones, thermal feedback, rollover and then, flashover. The students are shown. There can be multiple flashovers before the fuel load is depleted.

PREREQUISITE: NJDFS Firefighter Level I Certification

Class Limit: 12 Students

Class Hours: 3

Class minimum: 8

Location: Fire Training Center

Fee: \$65.00

Monday - Friday: (7:00 - 10:00 PM)

Instructors: ACFA Staff

Dates: Monday: October 2, 2023

Monday: November 6, 2023

FULL PPE & SCBA REQUIRED FOR THIS EVOLUTION

YOU MUST BRING A COMPLETED SCBA FACE FIT CERTIFICATION FORM. (SEE END OF THIS BOOK FOR FORM)

Individual Fire Companies and Departments may reserve the Flashover Simulator for training. Call the Fire Academy at 609-407-6743 for fee schedule and information.

**

ENGINE COMPANY OPERATIONS

Course # ECO - F23

Engine Company operations covers the 6 basic functions of an engine company, including hose length estimation, the route to the fire, the proper use of water, attack line size & nozzle selection. ECO will emphasize that the engine companies should be focused on three major tactical priorities on the fire ground: life safety, extinguishment, and property conservation. The Engine Company has specific functions & responsibilities it must perform on the fire ground. Engine company members have many duties to perform, often at the same time and with limited manpower, many tasks must be accomplished in a coordinated effort using basic principles of operation.

PREREQUISITE: Firefighter Level I

Class limit: 16

Class minimum: 12

Location: Fire Training Center

Dates: November 17, 18 & 19, 2023

Friday: (7:00 - 10:00 PM)

Saturday & Sunday: (8:30 am - 4:30 PM)

Class Hours:

Fee: \$175.00 (Lunch included
on Saturday & Sunday)

Lead Instructors: Sean Macri
Fire Chief, Hammonton FD

**FULL PPE, SCBA AND SPARE CYLINDER REQUIRED FOR ALL
EVOLUTIONS.**

**YOU MUST BRING A COMPLETED SCBA FACE FIT CERTIFICATION
FORM. (SEE END OF THIS BOOK FOR FORM)**

Atlantic County Fire Academy
5033 English Creek Avenue
Egg Harbor Township, NJ 08234

THERMAL IMAGING

Course # TI-F23

This class is an introduction course to basic uses of thermal imaging in the Fire Service. This course will cover understanding thermal imaging, thermal camera use in fire attack, search & rescue, hazardous materials, and wild land fires. Participants will learn how Thermal Imaging Cameras work, different options and also learn common mistakes made by Fire Fighters when using Thermal Imaging Cameras and how they commonly get into trouble with our new technology.

Wednesday: Classroom instruction includes thermal imaging theory, basic operation of different TI cameras, and thermal signature interpretation.

Thursday: Outside Evolutions include: Search & Rescue; HAZMAT; and Fire Attack.

PREREQUISITE: Firefighter Level I or 5 years experience in an organized fire department.

Class limit: 16

Class Hours: 6

Class minimum: 10

Location: Fire Training Center

Fee: \$ 35.00

Dates: October 25 & 26

Wednesday & Thursday: (7:00 - 10:00 pm)

Lead Instructor: Christopher Kislow,
Lieutenant, Pomona Fire Co.

**FULL PPE, SCBA AND SPARE CYLINDER REQUIRED FOR ALL
EVOLUTIONS – ONLY NEEDED FOR THURSDAY CLASS**

**YOU MAY BRING YOUR COMPANIES THERMAL CAMERA WITH A
LETTER FROM YOUR CHIEF, STATING YOU CAN USE IT IN THIS
CLASS.**

NATIONAL FIRE ACADEMY PROGRAMS

INCIDENT SAFETY OFFICER

Course #: ISO - F23

This course from the NFA examines the Safety Officer's role at emergency response situations. A specific focus on operations within an incident command system as a safety officer is the main theme.

PREREQUISITE: NJDFS Firefighter Level I Certification or 5 years experience in an emergency service organization.

Class Limit: 30

Class Hours: 16

Class minimum: 8

Location: Fire Training Center

Fee: \$60.00

Classroom: # 2

Lead Instructor: Michael Cahill,

Date: October 21 & 22, 2023

Fire Chief, Ventnor City Fire

Saturday & Sunday: (8:30 am - 4:30 PM)

Department

**



NJ DIVISION OF FIRE SAFETY PROGRAMS

I-200: BASIC ICS

Course # ICS I-200-F23

This course is required for firefighters who wish to apply for Incident Management System Level I Certification. All Fire Officers must complete Level I Certification as required by N.J.A.C.

PREREQUISITE: ICS 100 & I-700 or I-700A

Class Limit: Open
Minimum required is 10
Location: Fire Training Center
Classroom: #2

Date: October 21 & 22, 2023

Wednesday: (7:00 - 11:00 PM)

Academy

Saturday: (8:30 AM - 4:30 PM)

Class Hours: 12

Fee: In County Free

Out of County: \$50.00

Lead Instructor: Michael Corbo

Director (Ret), Atlantic County Fire

Deputy Chief (Ret), Pleasantville FD,

**

FIRE OFFICER LEVEL I

Course#: FOI-F23

This program is designed to prepare the participants to obtain the Fire Officer I Certification under the New Jersey Division of Fire Safety Fire Officer Regulations. The course also meets the objectives of NFPA 1021, Standard for Fire Officer Professional Qualifications.

Topics covered in this course will include human resource management, effective communications, community and governmental relations, inspection and investigation, administration, emergency service delivery, on-scene incident command, building construction, safety and PEOSHA regulations. The NJDFS Test will be administered at the end of class.

PREREQUISITE: Firefighter Level I or 5 years' experience in an emergency service organization.

Class Limit: 20 Students

Class minimum: 8

Responsible for the IFSTA Manual

Class Hours: 48

Fee: \$100.00, Students are

Location: Fire Training Center

Dates: January 9,11,13,16,18,20,23,25,27,30

Tuesday & Thursday: (7:00 - 10:00 pm.)

Saturdays: (8:30 am - 4:30 pm)

Academy,

Instructor: Michael J. Corbo,

Director, (Ret)Atlantic County Fire

Deputy Chief (Ret), Pleasantville FD,

Building Construction for the New Jersey Fire Service
Course #: BC - F23

To be safe and effective on the fireground it is critical for fire officers and firefighters to have exceptional knowledge and understanding of the types of buildings, building construction methods, occupancies, collapse hazards, construction materials and how the buildings they will be operating in will respond under fire conditions. Frank Brannigan, one of the authors of the building construction textbook adopted by New Jersey said it best when he coined the phrase “The building is your enemy, know your enemy.”

This two-day Building Construction Training Program will provide attendees with the requisite knowledge of building construction types, methods, materials, hazards, and operational considerations that fire officers and firefighters need to acquire to achieve success on the fireground. Fire officers who attend the program will meet the 12-hour building construction training requirements for Fire Officer I Certification in New Jersey.

**Students must attend both days of class to receive the 1.0 DFS instructor credit.
Attendees must hold a New Jersey Certified Fire I to attend.**

Class Limit: 30

Class minimum: 12

Location: Fire Training Center

Classroom: # 2

Date: November 4&5 2023

Saturday & Sunday: (8:30 am - 4:30 PM)

Class Hours: 12

Fee: \$60.00

Lead Instructor: Michael Cahill,
Fire Chief, Ventnor City Fire
Department

Atlantic County Fire Academy
5033 English Creek Avenue
Egg Harbor Township, NJ 08234

REGISTRATION FORM - FIREFIGHTER I

PLEASE PRINT OR TYPE THE FOLLOWING INFORMATION

Spring ____ Summer ____ Fall ____

STUDENT'S FULL NAME: _____

First

Middle

Last

HOME ADDRESS: _____

City

County

State

Zip

HOME TELEPHONE #: (____) _____ CELL PHONE #: (____) _____

DATE OF BIRTH: ____/____/____, AGE: _____, SS #: ____/____/____

DRIVER'S LICENSE #: _____

T-SHIRT SIZE: _____, GOLF SHIRT SIZE: _____, Email Address: _____

EDUCATION: HIGHEST GRADE LEVEL COMPLETED _____

FIRE COMPANY NAME: _____

FIRE COMPANY ADDRESS: _____

FIRE COMPANY TELEPHONE #: (____) _____ FAX #: (____) _____

Medical Form Attached: Yes ____ No ____ Date: _____

NOTE: Attach a copy of a completed and signed medical form to this registration form.
Forms can be found in the current course announcement.

Check, money orders, or company vouchers are to be made payable to the **Atlantic County Fire Academy** and mailed to the above address.

The applicant has read this form and by his/her signature agrees to abide by the regulations and age requirement of 18 established by the Atlantic County Firefighters' Association.

Signature of Applicant

Date

CERTIFICATION

I, _____, _____ of
Print Name Title

_____, do hereby certify that the information contained in
Company/Department
this registration form is true and accurate. I also confirm that the applicant is covered by a
Worker's Compensation Insurance Policy.

Signature of above Fire Chief or his Designee

Date

Atlantic County Fire Academy
5033 English Creek Avenue
Egg Harbor Township, NJ 08234

MEDICAL FORM – FIREFIGHTER I

To be filled out by a physician licensed in the State of New Jersey and returned with the Firefighter I Registration Form. Physical examination guidelines and Firefighter Performances are listed below. All sections of the physical must be properly filled out or the application will be returned.

PLEASE PRINT

NAME: _____
 First Initial Last Sex

Age: _____ Height: _____ Ft. _____ In. Weight: _____ lbs. Hearing: _____

Eyesight Left: _____ Right: _____ Both (corrected): _____ BP: _____

PHYSICAL EXAMINATION GUIDELINES

1. **EYES:** Must be 20/30 corrected (with glasses, contacts, or surgical procedures)
2. **HEARING:** Loss of hearing acuity so as to be unable to perceive sounds within normal voice range with or without hearing aid.
3. **NOSE:** Any significant nasal obstruction to free breathing not subject to correction by surgery.
4. **MOUTH:** Conditions with impair ability to communicate.
5. **NECK:** Problems resulting from (a) Goiter; (b) Limited range of motion; which prohibits range of motion, extension or free movement of neck; (c) Tracheotomy – existing openings at the lower portion of the neck connecting the windpipe to the outside environment for the purpose of easy breathing.
6. **PULMONARY:** Problems resulting from loss or removal of lung: (a) any pulmonary disorder which would limit the applicants ability to perform; (b) Pulmonary function test below normal; (c) Chronic Obstructive Pulmonary Disease/Asthma.
7. **CARDIO PULMONARY SYSTEM:** Problems resulting from heart disease or cardiomegaly.
8. **PERIPHERAL VASCULAR SYSTEM:** Problems resulting from: (a) Varicose veins; (b) Aneurysms; (c) Lymph edema; (d) Thrombophlebitis; (e) Arteriosclerosis Obliterans; (f) Buerger's Disease; (g) Raynaud's Disease; (h) Arterio-Venous Fistula; (i) High Blood Pressure, not able to be corrected or controlled by medication. Acceptable blood pressure reading should be as follows: Systolic not higher than 150 but not lower than 90. Diastolic maximum should be 100 mmhg, minimum 50 mmhg.
9. **ABDOMEN:** Problems resulting from (a) Organomegaly; (b) Signs of tenderness in an area; (c) Presence of masses such as hernias of various types.
10. **GENITOURINARY SYSTEM:** Problems arising from (a) Presence of abnormal masses; (b) Abnormal discharges from any of the orifices; (c) Active venereal diseases; (d) Parasitic diseases; (e) Varicocele and Varices; (f) Hydrocele.
11. **MUSCULO-SKELETAL SYSTEM:** Problems arising from (a) Congenital malformation; (b) Limitation of Motion; (c) Weakness; (d) Impairment or absence of one or more of the digits on either or both hands; (e) Impairment of function of the hands; (f) Missing toes if it interferes with ambulation; (g) Deformities of the spine, pelvis or extremities.
12. **OTHERS:** Problems arising of (a) Disqualification for psychiatric conditions must be determined by local agencies; (b) Allergic conditions which are chronic and incapacitating; (c) Severe anemia; (d) Active Peptic Ulcer; (e) Diabetes; (f) History

Atlantic County Fire Academy
5033 English Creek Avenue
Egg Harbor Township, NJ 08234

MEDICAL FORM - FIREFIGHTER I

of epilepsy or seizures other than documented febrile convulsions in childhood; (g) alcoholism or drug addiction; (h) Removal of vital organs; (i) Any other condition not listed above which would render the eligible incapable of performing their duties as a firefighter.

THESE MEDICAL GUIDELINES ARE TO BE FOLLOWED BY THE PHYSICIAN PERFORMING THE EXAMINATION. ANY ABNORMAL FINDINGS THAT WOULD PROHIBIT THE APPLICANT FROM OPERATING IN A SAFE MANNER OR PERFORMING ANY OF THE LISTED PERFORMANCES ARE GROUNDS FOR THE APPLICANT TO BE REJECTED.

FIREFIGHTER PERFORMANCIES

The following are a list of job performances that will be performed by the applicant during his/her training and throughout the course of his/her firefighting career.

1. Ability to raise, climb and work off of ladders above the ground.
2. Ability to wear a Self-Contained Breathing Apparatus (SCBA) and operate in an IDLH atmosphere including smoke and high heat environments.
3. Ability to work in a vision obscured environment.
4. Ability to hold and handle a charged hose line during extinguishment of a fire.
5. Ability to hold and handle hand tools, power tools and power saws during forcible entry, ventilation and firefighting operations.
6. Ability to crawl, walk, lift heavy objects and work in a stress-induced environment while wearing protective clothing and equipment weighing approximately 50 lbs.
7. Ability to hear radio transmission and perform two-way communication.
8. Ability to rescue and lift civilian victims and other firefighters in need of help.

I CERTIFY AS A PRACTICING PHYSICIAN IN THE STATE OF NEW JERSEY, THE APPLICANT IS FREE FROM ANY ACUTE OR CHRONIC DISEASE AND HAS NO PHYSICAL DEFECTS THAT WOULD HINDER HIS/HER ABILITY TO PERFORM THE DUTIES OF A FIREFIGHTER.

DATE EXAMINED _____ EXAMINED AT _____

PHYSICIAN'S PHONE NUMBER

PRINT PHYSICIAN'S NAME

SIGNATURE OF PHYSICIAN

**Atlantic County Fire Academy
5033 English Creek Avenue
Egg Harbor Township, NJ 08234**

Directions:

- 1.) Print your name and fire company and have your Fire Chief sign the Certification below prior to you participating or attending any live fire evolution or IDLH atmosphere requiring the use of a SCBA at Atlantic County Fire Academy.
- 2.) **Do not** fill out the rest of this form at this time. Bring it with you to the Fire Academy. The Lead Instructor at the Fire Academy will instruct you when to complete it.

FIRE CHIEF CERTIFICATION

Name of Firefighter

Name of Fire Company

The above firefighter has received and passed a SCBA Mask fit test and the results allow him/her to wear an SCBA during firefighting operations and IDLH Atmospheres.

Date: ____/____/____

Signature of Fire Chief/Authorized Designee

STUDENT/PARTICIPANT CERTIFICATION

I ____ of ____
(Print your Name) (Name of Fire Company)

hereby certify that I have received and passed at SCBA mask fit test in the last 12 months and that the SCBA Mask that I will be using during the live fire training today is the type and size that I was fit tested with.

I further certify that I understand that standing up in a live fire evolution may result in me receiving burns to my body.

I further certify that I have no known medical problem or medication that would prevent me from participating in any live fire evolution or IDLH atmosphere.

Date: ____/____/____

Signature of Student/Participant

Type of Training

Lead Instructor Signature

**Director of Training
Atlantic County Fire Academy
Atlantic County Fire Training Center
5033 English Creek Avenue
Egg Harbor Township, N.J. 08234-5743
Ph: 609-407-6743 Fax: 609-407-6745**

PLEASE PRINT ALL INFORMATION CAREFULLY

PRE-REGISTRATION FOR:	DATES OF COURSE:
PREREQUISITES:	ATTACH COPIES OF CERTIFICATES
COURSE #:	RETURN BY: 10 DAYS PRIOR TO START OF CLASS

LAST NAME	FIRST NAME	MI	SOCIAL SECURITY	PHONE NUMBER
1.				
2.				
3.				
4.				
5.				
6.				

Dress: CLASS ROOM: CASUAL

CUTOFFS or SHORTS NOT PERMITTED

DRILL FIELD: FULL PPE & SCBA WHEN NECESSARY

WE CERTIFY THAT THE STUDENTS LISTED ABOVE DO NOT HAVE ANY PHYSICAL AND/OR OTHER CONDITIONS THAT WOULD PREVENT THEM ACTIVELY PARTICIPATING IN ALL PORTIONS OF THIS COURSE. WE UNDERSTAND THAT PAYMENT FOR ANY MEDICAL, FIRST AID, DAMAGED EQUIPMENT, AND RELATED CHARGES WILL BE THE RESPONSIBILITY OF THE SPONSORING ORGANIZATION. SUBMISSION OF A SIGNED APPLICATION AUTOMATICALLY INDICATES COMPANY/DEPARTMENT AGREES TO POLICIES OUTLINED IN COURSE PUBLICATION.

FIRE DEPT/CO OR OTHER SPONSORING ORGANIZATION: PRINT CLEARLY NAME: _____ ADDRESS: _____ (Please include on all registration forms, No Exceptions)	
THE ABOVE CONDITIONS ARE UNDERSTOOD AND STUDENTS ATTENDING ARE AUTHORIZED BY:	PRINT SIGNATURE:
AUTHORIZED SIGNATURE DATE:	TITLE:
FORM OF PAYMENT: CO. CHECK _____ CO. VOUCHER/PO _____ PERSONAL CHECK _____ IN THE AMOUNT OF \$ _____ IS ATTACHED	PHONE: (WORK) () _____ PHONE: (HOME) () _____ STATION: () _____ FAX () _____
PAYMENT IS REQUIRED WITH SUBMISSION OF THIS REGISTRATION FORM. REFUNDS WILL BE MADE ACCORDING TO POLICIES OUTLINED IN COURSE PUBLICATION.	

Director of Training
Atlantic County Fire Academy
Atlantic County Fire Training Center
5033 English Creek Avenue
Egg Harbor Township, N.J. 08234-5743
Ph: 609-407-6743 Fax: 609-407-6745

PLEASE PRINT ALL INFORMATION CAREFULLY

PRE-REGISTRATION FOR:	DATES OF COURSE:
PREREQUISITES:	ATTACH COPIES OF CERTIFICATES
COURSE #:	RETURN BY: 10 DAYS PRIOR TO START OF CLASS

LAST NAME	FIRST NAME	MI	SOCIAL SECURITY	PHONE NUMBER
1.				
2.				
3.				
4.				
5.				
6.				

Dress: CLASSROOM: CASUAL CUTOFFS or SHORTS NOT PERMITTED
DRILL FIELD: FULL PPE & SCBA WHEN NECESSARY

WE CERTIFY THAT THE STUDENTS LISTED ABOVE DO NOT HAVE ANY PHYSICAL AND/OR OTHER CONDITIONS THAT WOULD PREVENT THEM ACTIVELY PARTICIPATING IN ALL PORTIONS OF THIS COURSE. WE UNDERSTAND THAT PAYMENT FOR ANY MEDICAL, FIRST AID, DAMAGED EQUIPMENT, AND RELATED CHARGES WILL BE THE RESPONSIBILITY OF THE SPONSORING ORGANIZATION. SUBMISSION OF A SIGNED APPLICATION AUTOMATICALLY INDICATES COMPANY/DEPARTMENT AGREES TO POLICIES OUTLINED IN COURSE PUBLICATION.

FIRE DEPT/CO OR OTHER SPONSORING ORGANIZATION: PRINT CLEARLY NAME: _____ ADDRESS: _____ (Please include on all registration forms, No Exceptions)	
THE ABOVE CONDITIONS ARE UNDERSTOOD AND STUDENTS ATTENDING ARE AUTHORIZED BY:	PRINT SIGNATURE:
AUTHORIZED SIGNATURE DATE:	TITLE:
FORM OF PAYMENT: CO. CHECK _____ CO. VOUCHER/PO _____ PERSONAL CHECK _____ IN THE AMOUNT OF \$ _____ IS ATTACHED	PHONE: (WORK) () _____ PHONE: (HOME) () _____ STATION: () _____ FAX () _____
PAYMENT IS REQUIRED WITH SUBMISSION OF THIS REGISTRATION FORM. REFUNDS WILL BE MADE ACCORDING TO POLICIES OUTLINED IN COURSE PUBLICATION.	

Director of Training
Atlantic County Fire Academy
Atlantic County Fire Training Center
5033 English Creek Avenue
Egg Harbor Township, N.J. 08234-5743
Ph: 609-407-6743 Fax: 609-407-6745

PLEASE PRINT ALL INFORMATION CAREFULLY

PRE-REGISTRATION FOR:	DATES OF COURSE:
PREREQUISITES:	ATTACH COPIES OF CERTIFICATES
COURSE #:	RETURN BY: 10 DAYS PRIOR TO START OF CLASS

LAST NAME	FIRST NAME	MI	SOCIAL SECURITY	PHONE NUMBER
1.				
2.				
3.				
4.				
5.				
6.				

Dress: CLASSROOM: CASUAL CUTOFFS or SHORTS NOT PERMITTED
DRILL FIELD: FULL PPE & SCBA WHEN NECESSARY

WE CERTIFY THAT THE STUDENTS LISTED ABOVE DO NOT HAVE ANY PHYSICAL AND/OR OTHER CONDITIONS THAT WOULD PREVENT THEM ACTIVELY PARTICIPATING IN ALL PORTIONS OF THIS COURSE. WE UNDERSTAND THAT PAYMENT FOR ANY MEDICAL, FIRST AID, DAMAGED EQUIPMENT, AND RELATED CHARGES WILL BE THE RESPONSIBILITY OF THE SPONSORING ORGANIZATION. SUBMISSION OF A SIGNED APPLICATION AUTOMATICALLY INDICATES COMPANY/DEPARTMENT AGREES TO POLICIES OUTLINED IN COURSE PUBLICATION.

FIRE DEPT/CO OR OTHER SPONSORING ORGANIZATION: PRINT CLEARLY NAME: _____ ADDRESS: _____ (Please include on all registration forms, No Exceptions)	
THE ABOVE CONDITIONS ARE UNDERSTOOD AND STUDENTS ATTENDING ARE AUTHORIZED BY:	PRINT SIGNATURE: _____
AUTHORIZED SIGNATURE _____ DATE: _____	TITLE: _____
FORM OF PAYMENT: CO. CHECK _____ CO. VOUCHER/PO _____ PERSONAL CHECK _____ IN THE AMOUNT OF \$ _____ IS ATTACHED	PHONE: (WORK) (_____) _____ PHONE: (HOME) (_____) _____ STATION: (_____) _____ FAX (_____) _____
PAYMENT IS REQUIRED WITH SUBMISSION OF THIS REGISTRATION FORM. REFUNDS WILL BE MADE ACCORDING TO POLICIES OUTLINED IN COURSE PUBLICATION.	

**Director of Training
Atlantic County Fire Academy
Atlantic County Fire Training Center
5033 English Creek Avenue
Egg Harbor Township, N.J. 08234-5743
Ph: 609-407-6743 Fax: 609-407-6745**

PLEASE PRINT ALL INFORMATION CAREFULLY

PRE-REGISTRATION FOR:	DATES OF COURSE:
PREREQUISITES	ATTACH COPIES OF CERTIFICATES
COURSE #:	RETURN BY: 10 DAYS PRIOR TO START OF CLASS

1.	LAST NAME	FIRST NAME	MI	SOCIAL SECURITY	PHONE NUMBER
2.					
3.					
4.					
5.					
6.					

Dress: CLASSROOM: CASUAL **CUTOFFS or SHORTS NOT PERMITTED**
 DRILL FIELD: FULL PPE & SCBA WHEN NECESSARY

WE CERTIFY THAT THE STUDENTS LISTED ABOVE DO NOT HAVE ANY PHYSICAL AND/OR OTHER CONDITIONS THAT WOULD PREVENT THEM ACTIVELY PARTICIPATING IN ALL PORTIONS OF THIS COURSE. WE UNDERSTAND THAT PAYMENT FOR ANY MEDICAL, FIRST AID, DAMAGED EQUIPMENT, AND RELATED CHARGES WILL BE THE RESPONSIBILITY OF THE SPONSORING ORGANIZATION. SUBMISSION OF A SIGNED APPLICATION AUTOMATICALLY INDICATES COMPANY/DEPARTMENT AGREES TO POLICIES OUTLINED IN COURSE PUBLICATION.

FIRE DEPT/CO OR OTHER SPONSORING ORGANIZATION: PRINT CLEARLY	
NAME: _____	
ADDRESS: _____	
(Please include on all registration forms, No Exceptions)	
THE ABOVE CONDITIONS ARE UNDERSTOOD AND STUDENTS ATTENDING ARE AUTHORIZED BY:	PRINT SIGNATURE:
AUTHORIZED SIGNATURE _____ DATE: _____	TITLE: _____
FORM OF PAYMENT: CO. CHECK _____ CO. VOUCHER/PO _____ PERSONAL CHECK _____ IN THE AMOUNT OF \$ _____ IS ATTACHED	PHONE: (WORK) () _____ PHONE: (HOME) () _____ STATION: () _____ FAX () _____
PAYMENT IS REQUIRED WITH SUBMISSION OF THIS REGISTRATION FORM. REFUNDS WILL BE MADE ACCORDING TO POLICIES OUTLINED IN COURSE PUBLICATION.	

**Director of Training
Atlantic County Fire Academy
Atlantic County Fire Training Center
5033 English Creek Avenue
Egg Harbor Township, N.J. 08234-5743
Ph: 609-407-6743 Fax: 609-407-6745**

PLEASE PRINT ALL INFORMATION CAREFULLY

PRE-REGISTRATION FOR:	DATES OF COURSE:
PREREQUISITES:	ATTACH COPIES OF CERTIFICATES
COURSE #:	RETURN BY: 10 DAYS PRIOR TO START OF CLASS

LAST NAME	FIRST NAME	MI	SOCIAL SECURITY	PHONE NUMBER
1.				
2.				
3.				
4.				
5.				
6.				

Dress: CLASSROOM: CASUAL

CUTOFFS or SHORTS NOT PERMITTED

DRILL FIELD: FULL PPE & SCBA WHEN NECESSARY

WE CERTIFY THAT THE STUDENTS LISTED ABOVE DO NOT HAVE ANY PHYSICAL AND/OR OTHER CONDITIONS THAT WOULD PREVENT THEM ACTIVELY PARTICIPATING IN ALL PORTIONS OF THIS COURSE. WE UNDERSTAND THAT PAYMENT FOR ANY MEDICAL, FIRST AID, DAMAGED EQUIPMENT, AND RELATED CHARGES WILL BE THE RESPONSIBILITY OF THE SPONSORING ORGANIZATION. SUBMISSION OF A SIGNED APPLICATION AUTOMATICALLY INDICATES COMPANY/DEPARTMENT AGREES TO POLICIES OUTLINED IN COURSE PUBLICATION.

FIRE DEPT/CO OR OTHER SPONSORING ORGANIZATION: PRINT CLEARLY NAME: _____ ADDRESS: _____ (Please include on all registration forms, No Exceptions)	
THE ABOVE CONDITIONS ARE UNDERSTOOD AND STUDENTS ATTENDING ARE AUTHORIZED BY:	PRINT SIGNATURE:
AUTHORIZED SIGNATURE _____ DATE: _____	TITLE:
FORM OF PAYMENT: CO. CHECK _____ CO. VOUCHER/PO _____ PERSONAL CHECK _____ IN THE AMOUNT OF \$ _____ IS ATTACHED	PHONE: (WORK) () _____ PHONE: (HOME) () _____ STATION: () _____ FAX () _____
PAYMENT IS REQUIRED WITH SUBMISSION OF THIS REGISTRATION FORM. REFUNDS WILL BE MADE ACCORDING TO POLICIES OUTLINED IN COURSE PUBLICATION.	